



Innovative.
Incognito.
Ingenious.



www.concealite.com

Our compact, virtually invisible emergency lighting fixtures preserve the integrity of architectural or interior designs, while meeting Code requirements. We are the very first to offer concealed emergency lighting, in fact we invented it! With over two decades of experience building and designing unique concealed fixtures, we remain the top choice for quality and cost-effective emergency lighting.

5000 Series Emergency Lighting

  (Self-Contained Battery System Included)

Aesthetics

Typical emergency lighting appliances are obtrusive and interrupt the aesthetic beauty of interior designs. Concealite has applied their patented concealed technology to emergency lighting to offer a beautiful alternative to "bug eyes". Only when the system is activated do the high-powered lamps become visible, rotating 180 degrees to begin operation. The result is a clean, almost invisible installation, that does not conflict with your interiors.

Architectural Features

- Standard white powder coat finish or units can be customized in the field using paint, wallpaper, or applique finishes.
- No minimum order for factory custom paint or metal finishes (ie. bronze, stainless, etc).
- Compact, completely self-contained units.
- Designed for wall or ceiling installations, including gypsum board, plaster, concrete, brick, or acoustical tile.
- Fully automatic operation, door is operated by a 12 Volt DC motor with integrated gear head.
- Choice of standard 90 minute, 2 or 4 hour operation.
- Fully adjustable 12, 20, 35, 50, or 75 Watt quartz halogen lamps are available for up to 150 Watt output.
- 3000 hour, MR-16 with GU-10 bi-pin twist lock base.
- Long-life 12 Volt sealed lead calcium recombinant battery is standard. Optional nickel cadmium batteries are available.
- Fully automatic solid-state charger with universal transformer (120/277 Volt) comes standard or 347 Volt transformer is optional.
- Self-diagnostic controls are an available option.
- UL Listed.
- Frameless mounting system available (for standard back boxes only).

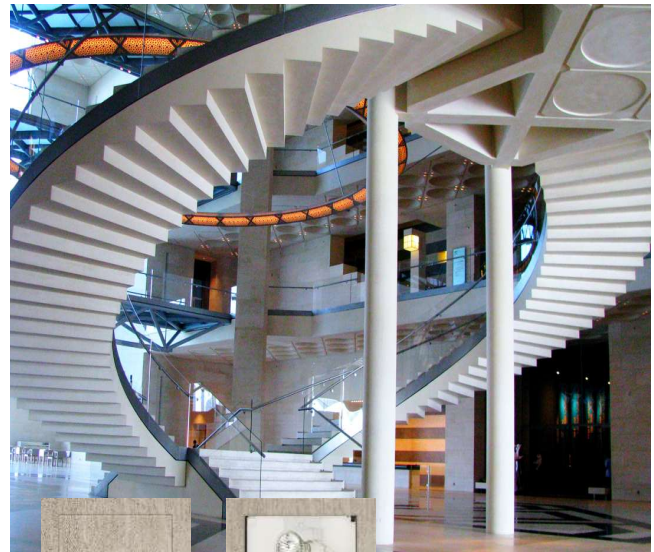

Art Museum, Doha, Qatar

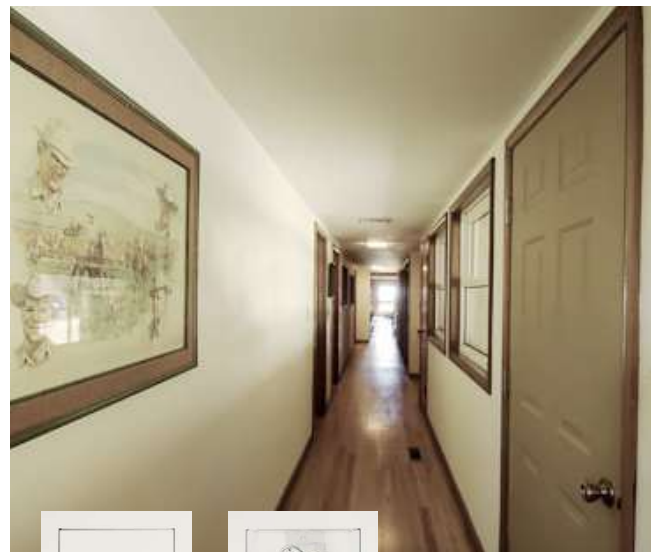

Hotel Corridor, Plano TX

5000 Series Emergency Lighting



BATTERY (Self-Contained Battery System Included)

FIXTURE SCHEDULE	FIXTURE TYPE:	PROJECT NAME/REF:
APPROVAL:	LAMP TYPE:	PROJECT LOCATION:

Installation

This fixture utilizes a recessed flange for flush mounting in either a wall or ceiling. Normal power (120/277 Volts) and remote test module (optional) connections to the unit are made through conduit knockouts on the recessed enclosure. The door, lamp, and motor drive assembly is inserted into the recessed enclosure. The assembly is then secured in place with two (2) concealed bolts that allow for adjustment to the wall or ceiling thickness. For complete installation and operation instructions, please refer to the instruction sheet included with each unit.

New Projects

For new projects, a single enclosure is mounted before the wall or ceiling material is installed.

Retrofit/Remodeling Projects

For retrofit/remodeling applications a multi-section (suffix RB) enclosure is available. See options and technical data section for details.

Product Specifications

The emergency lighting unit shall be Concealite Series 5000 and will conform to UL Standard #924 and be installed in accordance to Article 700 of the National Electrical Code. The standard unit shall be a white powder coat finish, and can be custom finished by factory, or in the field, using paint, wallpaper or applique. The unit will be stored in a retracted position during normal power conditions. Upon the loss of utility power, the unit will be deployed into the open position and the lamps energized. Restoration of utility power will cause the unit to retract to the stored position, and the lamps to extinguish. The unit will provide emergency lighting for a minimum of 90 minutes. Motor shall be a 12 Volt sealed permanent magnet type with a 30 year service life. The electronics shall be a solid state design. The maximum power draw is no more than 23 watts. The charger will include LVD and brownout circuits. Unit will be rated at 120/277 VAC, 60hz (347 Volt optional). The unit shall have an integral test switch and pilot light to indicate charge.

Limited Warranty

All Concealite equipment is guaranteed against defects in materials and workmanship by the manufacturer for a period of three years from date of shipment under normal operations and proper use. Correction of all defects shall be by replacement or repair (at our discretion) and shall constitute fulfillment of all manufacturer's obligations.

5000 Series



Unit Dimensions Including Frame Dimensions

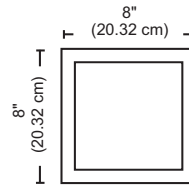

Back Box Dimensions

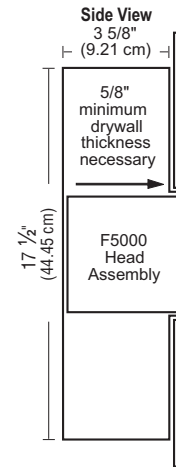

Note:
Unit requires finished opening of 7 1/4"H x 6 3/4"W.
Unit depth of 3 5/8" allows for installation into wall or ceiling.

Standard (New Construction)

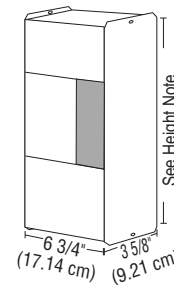

Retro-Fit (Install into Existing Construction)

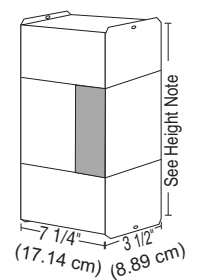

Height Note: Back box heights are given by model number. For height dimensions, refer to the Back Box Dimensions cut sheet.

Ordering Information

Series	F5	20	2	OPTIONS
Type	<ul style="list-style-type: none"> 12 Two (2)12 Watt Quartz Halogen Lamps 20 Two (2)20 Watt Quartz Halogen Lamps 35 Two (2)35 Watt Quartz Halogen Lamps 50 Two (2)50 Watt Quartz Halogen Lamps 75 Two (2)75 Watt Quartz Halogen Lamps 			
Hours of Operation	<ul style="list-style-type: none"> 90 1 1/2 Hours (12, 20, 35, 50, 75 Watt) 2 2 Hours (12, 20, 35, 50 Watt) 4 4 Hours (12, 20, 35 Watt) 			
Options	<ul style="list-style-type: none"> FMS Frameless Appearance (Frameless Mounting System) For Standard Back Boxes Only PT Plaster Trim SD Self-Diagnostic RT Remote Test Module SM Surface Mount Enclosure RB Retro Fit Back Box (See Back Box Dimensions) TBAR T-Bar Mounting Kit CBLK C-Block Back Box (Not available for F5-35-4, F5-50-2 or F5-75-90) DL Damp Location IR Infrared Hand Held Remote Testing TDR Time Delay Relay (Contact Factory for Delay Times and Pricing) NC Nickel Cadmium Batteries 220 220VAC, 50HZ 347 347VAC, 50HZ CF Custom Finish (Specify 4 digit RAL #) CCEA City of Chicago Environmental Air (Formally Chicago Plenum). 			

RB Option:
Existing Construction Installation
Our unique to the market Retro Back Box is available that allows installation into existing Construction.



202 Elk Street, P.O. Box 160
Elkton, SD 57026
Phone: (605)542-4444
Fax: (605)542-3333
www.concealite.com

Concealite's Back Box Dimensions

Options and Technical Data

Recessed Battery Back Boxes

New Construction

Note: R-1 fits FA100, R4000, and MX I. F5000 based on size (see below).

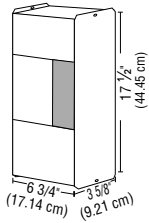

**R-1
Lead Acid**
#F5-12-90
#F5-12-2
#F5-20-90

**R-1
NiCad**
#F5-12-90
#F5-12-2
#F5-20-90
#F5-20-2

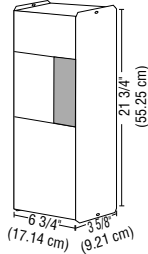

**R-2
Lead Acid**
#F5-12-4
#F5-20-2
#F5-35-90
#F5-35-2
#F5-50-90

**R-2
NiCad**
#F5-12-4
#F5-20-4
#F5-35-90
#F5-35-2
#F5-50-90

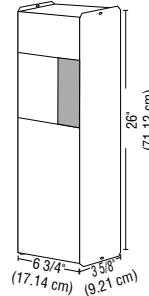

**R-3
Lead Acid**
#F5-20-4
#F5-50-2
#F5-75-90

**R-3
NiCad**
#F5-50-2
#F5-75-90

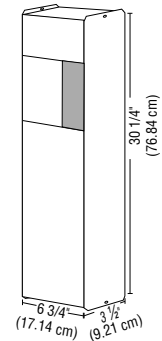

**R-4
Lead Acid**
#F5-35-4

**R-4
NiCad**
#F5-35-4

Retrofit Back Boxes

Existing Construction

Note: Retro-1 fits FA100, R4000, and MX I. F5000 based on size (see below).

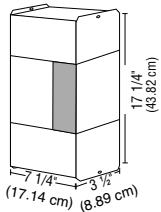

**Retro-1
Lead Acid**
#F5-12-90
#F5-12-2
#F5-20-90

**Retro-1
NiCad**
#F5-12-90
#F5-12-2
#F5-20-90
#F5-20-2

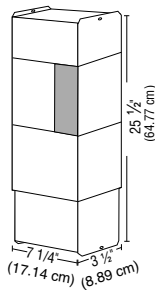

**Retro-3
Lead Acid**
#F5-12-4
#F5-20-2
#F5-20-4
#F5-35-90
#F5-35-2
#F5-50-90
#F5-50-2
#F5-75-90

**Retro-3
NiCad**
#F5-12-4
#F5-20-4
#F5-35-90
#F5-35-2
#F5-50-90
#F5-50-2
#F5-75-90

Surface Mount Back Boxes

New Construction

Note: SM-2 fits FA100, R4000, and MX I. F5000 based on size (see below).

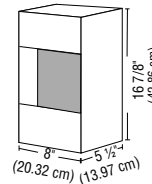

**SM-2
Lead Acid**
#F5-12-90
#F5-12-2
#F5-12-4
#F5-20-90
#F5-20-2
#F5-20-90
#F5-35-2
#F5-50-90

**SM-2
NiCad**
#F5-12-4
#F5-20-4
#F5-35-90
#F5-35-2
#F5-50-90

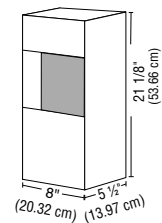

**SM-4
Lead Acid**
#F5-20-4
#F5-35-4
#F5-50-2
#F5-75-90

**SM-4
NiCad**
#F5-35-4
#F5-50-2
#F5-75-90

C-Block

New Construction

Note: C-Block fits R4000, FA100, and MX I. F5000 based on size/battery (see below).

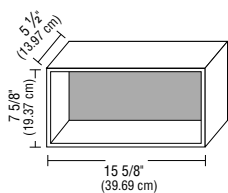

**C-Block
Lead Acid**
#F5-12-90
#F5-12-2
#F5-12-4
#F5-20-90
#F5-20-2
#F5-35-90
#F5-35-2
#F5-50-90

**C-Block
NiCad**
#F5-12-90
#F5-12-2
#F5-12-4
#F5-20-90
#F5-20-4
#F5-35-90
#F5-35-2
#F5-50-90



202 Elk Street, P.O. Box 160
Elkton, SD 57026
Phone: (605)542-4444
Fax: (605)542-3333
www.concealite.com