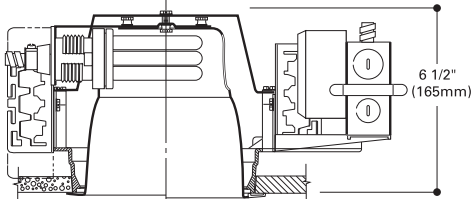
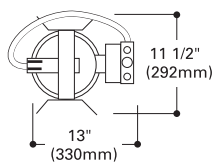

2 LAMP EMERGENCY OPERATION

DIMENSIONS

Aperture Size: **6**

Lamp: 26W, 32W Triple

Lamp and Lamp Image Cutoff: 55°

ORDER HOUSING, TRIM AND ACCESSORIES SEPARATELY

Aperture: 5 11/16" (144mm) Cutout: 6 3/8" (162mm) OD: 7" (178mm)

Housing	Ballast ⁽²⁾	Trims*	Finish ⁽⁵⁾	Accessories ⁽³⁾	Slope Ceiling Adapter
C6132 =6" 26W, 32W (1) Lamp 4-Pin Lamps Gx24q-3 base (Electronic, dimming and DLS ballasts)	E, E1EM ⁽⁶⁾, EEM ⁽⁶⁾, ECP ⁽⁷⁾ =120V through 277V Electronic 3E =347V Electronic 1D, 1DEM, 1DCP =120V Dimming ⁽¹⁾ 2D, 2DCP =277V Dimming ⁽¹⁾ DLS1 ⁽⁸⁾ =120V to 277V Digital Lighting System	6150 =Reflector with Polymer Trim 6151 =Self Flanged Reflector * Specify E on trim for IEM	LI =Low Iridescent H =Haze S =Straw WH =Wheat W =High Gloss White BB =Black Baffle (on 6150 only) WB =White Baffle (on 6150 only)	Trim Rings TRM6P =White Metal TRM6MB =Black Metal TRR6 =Rimless Decorative Trim Rings = Only for use with 6150 See Pages 681-683	HSA6XX =Specify Slope HB26 =26" Long 1-1/2" C-Channel Bar Hangers HB50 =50" Long 1-1/2" C-Channel Bar Hangers RMB22 =22" Long Wood Joist Mounting Bars

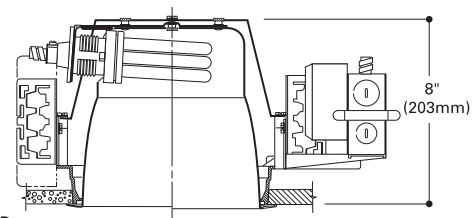
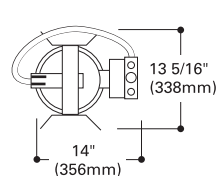
Aperture Size: **7 3/8**

Lamp: 26W, 32W, 42W Triple

Lamp and Lamp Image Cutoff: 55°

ORDER HOUSING, TRIM AND ACCESSORIES SEPARATELY

Aperture: 7 3/8" (187mm) Cutout: 8 1/8" (206mm) OD: 8 3/4" (222mm)

Housing	Ballast ⁽²⁾	Trims*	Finish ⁽⁵⁾	Accessories ⁽³⁾	Slope Ceiling Adapter
C7132 =7 3/8" 26W, 32W (1) Lamp C7142 =7 3/8" 42W, (1) Lamp 4-Pin Lamps Gx24q-3 base (Electronic, dimming and DLS ballasts)	E, E1EM ⁽⁶⁾, EEM ⁽⁶⁾, ECP ⁽⁷⁾ =120V through 277V Electronic 3E =347V Electronic 1D, 1DEM, 1DCP =120V Dimming ⁽¹⁾ 2D, 2DCP =277V Dimming ⁽¹⁾ DLS1 ⁽⁸⁾ =120V to 277V Digital Lighting System	7150 =Reflector with Polymer Trim 7151 =Self Flanged Reflector * Specify E on trim for IEM	LI =Low Iridescent H =Haze S =Straw WH =Wheat WMH =Warm Haze W =High Gloss White BB =Black Baffle (on 7150 only) WB =White Baffle (on 7150 only)	Trim Rings TRM7P =White Metal TRM7MB =Black Metal TRR7 =Rimless Decorative Trim Rings = Only for use with 7150 See Pages 681-683	HSA7XX =Specify Slope HB26 =26" Long 1-1/2" C-Channel Bar Hangers HB50 =50" Long 1-1/2" C-Channel Bar Hangers RMB22 =22" Long Wood Joist Mounting Bars

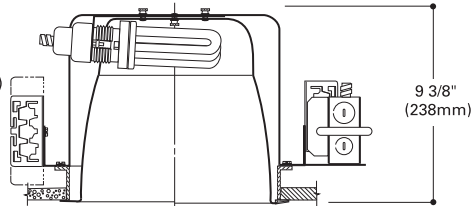
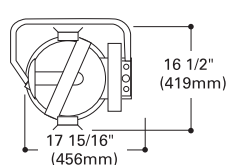
Aperture Size: **9 1/2**

Lamp: (2) 26W, (2) 32W, (2) 42W Triple

Lamp and Lamp Image Cutoff: 55°

ORDER HOUSING, TRIM AND ACCESSORIES SEPARATELY

Aperture: 9 1/2" (241mm) Cutout: 10 1/4" (260mm) OD: 10 1/2" (266mm)

Housing	Ballast ⁽²⁾	Trims*	Finish ⁽⁵⁾	Accessories ⁽³⁾	Slope Ceiling Adapter
C9242 =9 1/2" 42W, 32W, 26W (2) Lamp 4-Pin Lamps 26W Gx24q-3 base 32W Gx24q-3 base 42W Gx24q-4 base (Electronic and Dimming Ballasts)	E, E1EM ⁽⁶⁾, EEM ⁽⁶⁾, ECP ⁽⁷⁾ =120V through 277V Electronic 1D, 1DEM, 1DCP =120V Dimming ⁽¹⁾ 2D, 2DCP =277V Dimming ⁽¹⁾ 3E =347V Electronic DLS1 ⁽⁸⁾ =120V to 277V Digital Lighting System E2C =2 Ballasts for Hi-Low Switching E2CMS =2 Circuit Master Satellite (2 Housings Order 2 Trims)	9250 =Reflector with Polymer Trim 9251 =Self Flanged Reflector * Specify E on trim for IEM	LI =Low Iridescent H =Haze S =Straw WH =Wheat WMH =Warm Haze W =High Gloss White BB =Black Baffle (on 9250 only) WB =White Baffle (on 9250 only)	HB26 =26" Long 1-1/2" C-Channel Bar Hangers HB50 =50" Long 1-1/2" C-Channel Bar Hangers RMB22 =22" Long Wood Joist Mounting Bars HSA10XX =Slope Ceiling Adapter (Specify Slope)	

NOTES: ⁽¹⁾ Lutron® Compact SE 5% or 100% compatible dimming ballast. 4-pin lamps only. ⁽²⁾ Products also available in non-US voltages and 50Hz for international markets. Consult your Cooper Lighting Representative for availability and ordering information. ⁽³⁾ Accessories should be ordered separately. For additional options please consult your Cooper Lighting Representative. ⁽⁴⁾ Alzak is a registered trademark of Aluminum Company of America. ⁽⁵⁾ For White Painted Flange (on self flanged reflectors) add **WF** to Reflector Finish. ⁽⁶⁾ IEM=Internal Emergency Module Option, EEM=Emergency Module Option. ⁽⁷⁾ CP=Chicago Plenum Option. ⁽⁸⁾ See DLS Section for



C6132, C7142, C9242

Horizontal Triple

WIDE BEAM DOWNLIGHT

- One piece Alzak ⁽⁴⁾ reflector with spun parabolic contour provides 55° cutoff to lamp and lamp image
- All finishes are low iridescent to eliminate rainbowing
- Integral reflector vents. Positive reflector mounting via keyed holes and screws
- One piece vented die cast aluminum cap
- Die cast aluminum 1 1/2" deep collar
- Exclusive universal mounting bracket adjusts 5" vertically
- Junction box with 1/2" and 3/4" pryouts, listed for eight #12g 90° C conductors
- Electronic ballast with integral fuse, >99% power factor and <10% THD. Electronic ballasts have end of Life protection standard.
- Luminaire Efficacy Rating C6132-6150LI-35.61 C9242-9250LI-45.50 C7132-7150-42.92
- UL and cUL listed, feed through junction box, UL/cUL damp location