**9021WH**

Lytespan® Track Lighting **9021**

Page 1 of 1

Mini Universal

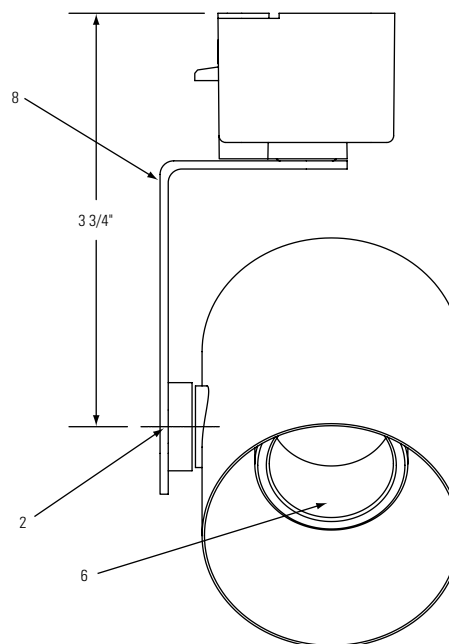
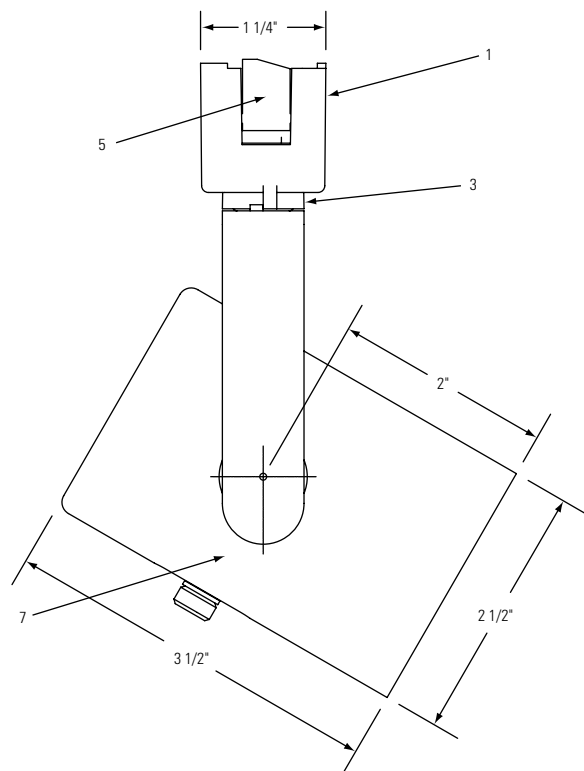

Ordering Information

Catalog No.	Finishes	Mounting	Lamps
9021WH 9021BK 9021AL	Matte White Matte Black Metallic Aluminum	Lytespan Track	PAR16, R20, PAR20, PAR 30 and PAR38 from 30W to 250W

Features

- Lytespan Attachment Fitting:** Molded polycarbonate. Integral color. Adapter twists onto track, locks on.
- Trunion Mounting:** Tensioned with internal spring washer and vibration resistant nut. Adjusts vertically 90°.
- Pivot mounting:** Tensioned; adjusts horizontally 350° stop.
- Movable Brass Contact:** Extends for connection to 2nd circuit in Advent Lytespan Track
- Push Tab:** Molded Polycarbonate. Detaches unit.
- Porcelain Socket**
- Housing:** .040" aluminum
- 1/8" Steel Yoke**
- Sliding socket accommodates a variety of lamps and sockets

Electrical

Porcelain socket, medium base, nickel plated screw shell. No 18 braided SF-1 leads.

Finish

All painted finishes are baked enamel.

Labels

UL, cUL

Job Information

Type:

Job Name:

Cat. No.:

Lamp(s):

Notes:

Lightolier a Genlyte company

631 Airport Road, Fall River, MA 02720 • (508) 679-8131 • Fax (508) 674-4710

We reserve the right to change details of design, materials and finish.

© 2006 Genlyte Group LLC • A1006

www.lightolier.com

LIGHTOLIER®