

DESCRIPTION

The Paralux III Series features recessed aesthetics and the latest in energy efficient technology. The luminaire incorporates a nominal 3" deep precision cell louver into a 4-3/4" deep para-contoured fixture housing. This combination creates a total high performance parabolic optical assembly for optimum performance. The series is compatible with all of today's popular ceiling systems and is available with a number of options and accessories for application versatility. The high performance luminaire is designed to offer maximum efficiency and performance for today's unique interior specifications. The Paralux III series is an excellent choice for commercial office spaces, schools, hospitals or retail merchandising areas.

SPECIFICATION FEATURES

Construction

4-3/4" deep, para-contoured housing, die formed of code gauge, prime cold rolled steel. Die embossed housing has full length die formed stiffeners for added strength. Contoured ballast/wireway cover is easily removed. Die formed captive lampholder bracket fully encloses lampholder wiring permitting easy lampholder replacement. Heavy gauge end plates are securely attached with interlocking tabs and screws. Four auxiliary fixture end suspension points provided. KOs for continuous row wiring. End plates have integral Grid-Lock feature for safety and convenience.

Electrical**

Ballasts are CBM/ETL Class "P" and are positively secured. 2G11 base lampholders have double-edge wiping action pressure lock contacts with vertically oriented lamp support clips. UL/CUL listed. Suitable for damp locations.

Finish

Lighting grade, baked white enamel finish. Multistage, iron phosphate pretreatment ensures maximum bonding and rust inhibition.

Hinging/Latching

Positive spring loaded, self locking, steel latches. Safety lock T-hinges allow hinging and latching from either side.

Louver

Die formed of low iridescent, vertical grain anodized aluminum. Finish is Anodic oxide coating. Accurate precision parabolic cells are held in place with interlocking feature. True-cut mitered corners. Black reveal with integral mechanical light seal around entire perimeter of louver. Louver protected from construction contaminants by polyethylene cover.



2EP3GAX
2BX40
3BX40

9 or 16 Cell

2' X 2' PARABOLIC
2 OR 3 LAMP BIAIXIAL
SEMI-SPECULAR, SPECULAR
OR WHITE PAINTED LOUVER

Paralux III
Recessed Static or Air
Supply Troffer

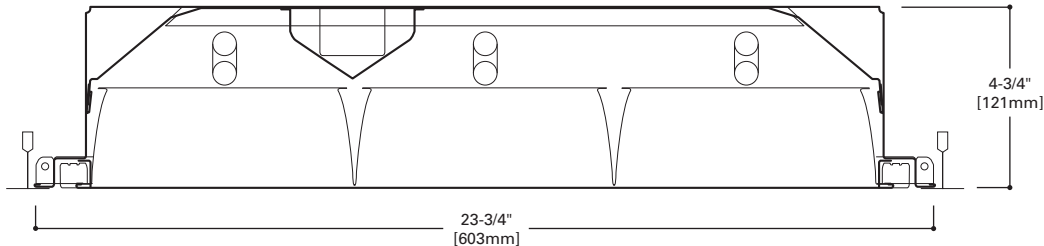

MOUNTING DATA

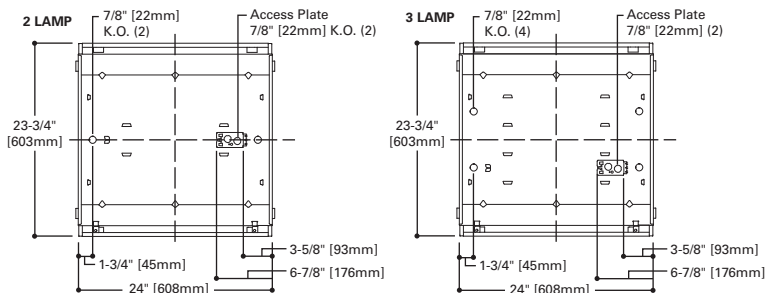

LAMP CONFIGURATIONS

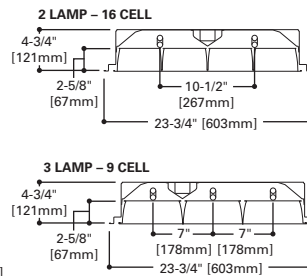

CEILING COMPATIBILITY

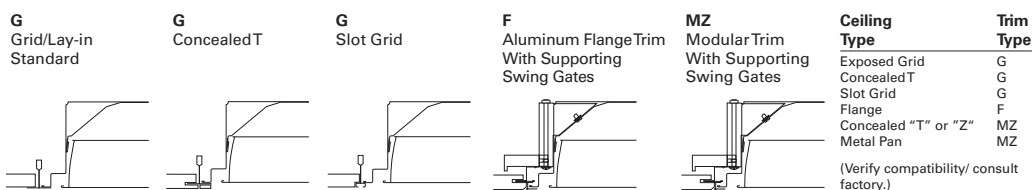

ENERGY DATA

Input Watts:
EB Ballast & STD Lamps
2BX40 (67), 3BX40 (110)

Luminaire Efficacy Rating
LER = FP-57

Catalog Number: 2EP3GAX-3BX40S33I

Yearly Cost of 1000 lumens,
3000 hrs at .08 KWH = \$4.21

**Reference the lamp/ballast data in the Technical Section for specific lamp/ballast requirements.

LAMPS CONTAIN MERCURY. DISPOSE ACCORDING TO LOCAL, STATE OR FEDERAL LAWS

LINEAR DISCONNECT

Safe and convenient means of disconnecting power.

PHOTOMETRICS

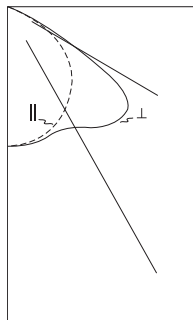

2EP3GAX-2BX40S44I
 Electronic Ballast
 F40BX/35K/RS Lamps
 3150 Lumens
 Spacing criterion:
 (II) 1.2 x mounting
 height, (L) 2.2 x
 mounting height
 Efficiency 63.7%
 Test Report:
 2EP3GAX2BX40S44I.IES
 LER = FP-52
 Yearly Cost of 1000
 lumens, 3000 hrs at
 .08 KWH = \$4.62

Candlepower

Angle	Along II	45°	Across L
0	1262	1262	1262
5	1254	1241	1233
10	1225	1218	1215
15	1188	1211	1264
20	1143	1197	1331
25	1097	1200	1471
30	1039	1245	1648
35	970	1311	1799
40	892	1379	2007
45	800	1416	2283
50	690	1405	1920
55	543	1152	938
60	338	543	284
65	145	118	85
70	49	43	40
75	23	21	20
80	10	10	9
85	3	3	3
90	0	0	0

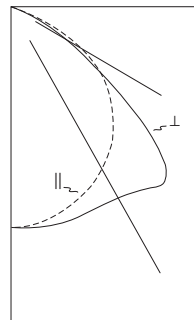

2EP3GAX-3BX40S33I
 Electronic Ballast
 F40BX/35/RS Lamps
 3150 Lumens
 Spacing criterion:
 (II) 1.2 x mounting
 height, (L) 1.7 x
 mounting height
 Efficiency 69.2%
 Test Report:
 2EP3GX3BX40S33I.IES
 LER = FP-57
 Yearly Cost of 1000
 lumens, 3000 hrs at
 .08 KWH = \$4.21

Candlepower

Angle	Along II	45°	Across L
0	2481	2481	2481
5	2465	2488	2513
10	2418	2495	2565
15	2354	2490	2604
20	2272	2469	2692
25	2174	2461	2838
30	2069	2475	3217
35	1932	2538	3351
40	1783	2631	2694
45	1606	2434	1834
50	1393	1735	1149
55	1143	1046	744
60	809	579	453
65	359	257	175
70	116	85	71
75	37	36	37
80	15	17	17
85	4	5	5
90	0	0	0

Coefficients of Utilization

rc	Effective floor cavity reflectance						0%								
	80%		70%		50%										
rw	70	50	30	10	70	50	30	10	50	30	10	50	30	10	0
RCR															
0	76	76	76	76	74	74	74	74	71	71	71	68	68	68	65
1	71	68	66	64	69	67	65	63	64	62	61	62	60	59	59
2	65	60	57	54	63	59	56	53	57	54	52	55	53	51	50
3	60	54	49	45	58	53	48	45	51	47	44	49	46	43	41
4	55	48	43	39	53	47	42	38	45	41	38	44	40	37	36
5	50	42	37	33	49	42	37	33	40	36	33	39	35	32	31
6	46	38	33	29	45	37	32	29	36	32	28	35	31	28	27
7	43	34	29	25	42	34	29	25	33	28	25	32	28	25	23
8	40	31	26	22	39	31	26	22	30	25	22	29	25	22	20
9	37	28	23	20	36	28	23	20	27	23	20	27	22	19	18
10	34	26	21	18	33	26	21	18	25	21	18	24	20	17	16

Coefficients of Utilization

rc	Effective floor cavity reflectance						0%								
	80%		70%		50%										
rw	70	50	30	10	70	50	30	10	50	30	10	50	30	10	0
RCR															
0	82	82	82	82	80	80	80	80	77	77	77	74	74	74	71
1	77	74	72	70	75	73	71	69	70	68	67	67	66	65	65
2	71	67	63	59	70	65	62	59	63	60	57	61	58	56	55
3	66	60	55	51	64	59	54	51	57	53	50	55	52	49	47
4	61	53	48	44	59	53	48	44	51	47	43	49	46	43	41
5	56	48	43	38	55	47	42	38	46	41	38	45	41	37	36
6	52	43	38	34	51	43	38	34	42	37	33	41	36	33	32
7	48	40	34	30	47	39	34	30	38	33	30	37	33	29	28
8	45	36	31	27	44	36	30	27	35	30	27	34	30	26	25
9	42	33	28	24	41	33	28	24	32	27	24	31	27	24	22
10	39	30	25	22	38	30	25	22	29	25	22	29	25	22	20

Zonal Lumen Summary

Zone	Lumens	%Lamp	%Fixture
0-30	1039	16.5	25.9
0-40	1881	29.9	46.9
0-60	3826	60.7	95.3
0-90	4014	63.7	100.0
0-180	4014	63.7	100.0

Typical VCP Percentages

Room Size (Ft.)	Height Along		Height Across	
	8.5'	10.0'	8.5'	10.0'
20 x 20	77	70	74	66
30 x 30	83	77	81	74
30 x 60	86	81	85	79
60 x 30	85	81	84	79
60 x 60	88	84	87	83

Zonal Lumen Summary

Zone	Lumens	%Lamp	%Fixture
0-30	2099	22.2	32.1
0-40	3717	39.3	56.9
0-60	6188	65.5	94.7
0-90	6537	69.2	100.0
0-180	6537	69.2	100.0

Typical VCP Percentages

Room Size (Ft.)	Height Along		Height Across	
	8.5'	10.0'	8.5'	10.0'
20 x 20	63	56	72	65
30 x 30	72	65	78	71
30 x 60	76	70	80	75
60 x 30	77	71	81	77
60 x 60	80	75	83	79

ORDERING INFORMATION

SAMPLE NUMBER: 2EP3GAX-2BX40S33I-120V-EB51-U

<p>Rating Blank=Standard ATW-SW4=Chicago Rated</p> <p>HR=Heat Removal⁽¹⁾</p> <p>Width 2=2' Width</p> <p>EP=Paralux Louver</p> <p>3=3" Louver Depth</p> <p>Trim Type G=Grid/Lay-in (Standard) G=Concealed T/Slot Grid⁽⁷⁾ F=Aluminum Flange Trim⁽⁸⁾ MZ=Modular Trim</p> <p>AX=Air Supply Floating Louver X=Blank Side/Floating Louver - Non-Air Supply (Omit A) AVX=Air Supply Floating Louver with Directional Air Vane (Add V)</p>	<p>Number of Lamps 2=2 Lamps 3=3 Lamps⁽³⁾</p> <p>Wattage (Length) BX40=40W Biax (24")</p> <p>Louver Color S=Silver W=White</p> <p>Cell Configuration 33=3 Rows of 3, 9 Cell 44=4 Rows of 4, 16 Cell</p> <p>Louver Finish I=Semi-Specular/Haze (Low Iridescent) Standard (Silver Only) MI=Specular/Mirrored (Low Iridescent) (Silver Only) P=Painted (White only)</p> <p>Option - Aluminum Flange Trim⁽⁸⁾ Blank=SW (Single White) Type Color 'S' Single 'N' Natural 'R' In Row 'W' White 'E' End of Row</p>	<p>Voltage⁽⁴⁾ 120V=120 Volt 277V=277 Volt 347V=347 Volt UNV=Universal Voltage 120-277⁽⁵⁾</p> <p>Options GL=Single Element Fuse GM=Double Element Fuse WTR=White Reveal Lamps=Lamps Installed (refer to lamp ordering options) Flex=Flex Installed (Reference Flex ordering information) EL=Emergency Installed⁽⁶⁾</p>	<p>Ballast Type Blank=Standard Magnetic Ballast (Biax & 20W)⁽⁹⁾ EB5_=T5 Biax Electronic Instant⁽⁹⁾ Start. Total Harmonic Distortion < 20% TEB5_=T5 Biax Electronic Instant⁽⁹⁾ Start. Total Harmonic Distortion < 10% ER5_=T5 Biax Electronic Program Rapid Start. Total Harmonic Distortion < 10%</p> <p>Number of Ballasts 1=1 Ballast 2=2 Ballasts 3=3 Ballasts</p>	<p>Options PAF=Painted After Fabrication REP=Riveted Endplates</p> <p>Packaging U=Unit Pack PAL=Job Pack, out of carton PALC=Job Pack, in carton</p>
---	--	--	---	--

ACCESSORIES

EQ-CLIP-U=T-BAR Safety Earthquake Clips⁽²⁾

SHIPPING DATA

Catalog No.	Wt.
2EP3GAX-2BX40S33I	28 lbs.
2EP3GAX-3BX40S33I	28 lbs.

NOTES: ⁽¹⁾ Integral end plate grid lock feature not available in heat removal. ⁽²⁾ An EQ Grid Clip is recommended for all 9/16" ceiling systems. Four required per fixture. ⁽³⁾ Standard off-center ballast on 3-lamp fixtures. ⁽⁴⁾ Products also available in non-US voltages and frequencies for international markets. ⁽⁵⁾ Not available when specifying emergency, voltage must be specific. ⁽⁶⁾ Fixtures equipped with "EL" option may require a 5-1/2" housing depth. If installing in field, must use low profile battery pack. ⁽⁷⁾ Louver is recessed by 5/16" in Concealed T or Slot Grid T. ⁽⁸⁾ Specify row configuration, type in catalog number when ordering complete fixture. ⁽⁹⁾ Not available in UNV voltages. Must specify voltage.

For complete product data, reference the Fluorescent Specification binder. Specifications & dimensions subject to change without notice. Consult your Cooper Lighting Representative for availability and ordering information.



Eaton
 1121 Highway 74 South
 Peachtree City, GA 30269
 P: 770-486-4800
 www.eaton.com/lighting

Specifications and dimensions subject to change without notice.