

## DESCRIPTION

The Paralux III Series features recessed aesthetics and the latest in energy efficient technology. The luminaire incorporates a nominal 3" deep precision cell louver into a 4-3/4" deep para-contoured fixture housing. This combination creates a total high performance parabolic optical assembly for optimum performance. The series is compatible with all of today's popular ceiling systems and is available with a number of options and accessories for application versatility. The high performance luminaire is designed to offer maximum efficiency and performance for today's unique interior specifications. The Paralux III series is an excellent choice for commercial office spaces, schools, hospitals or retail merchandising areas.

## SPECIFICATION FEATURES

### Construction

4-3/4" deep, para-contoured housing, die formed of code gauge, prime cold rolled steel. Die embossed housing has full length die formed stiffeners for added strength. Contoured ballast/wireway cover is easily removed without tools. Die formed captive lampholder bracket fully encloses lampholder wiring permitting easy lampholder replacement. Heavy end plates are securely attached with interlocking tabs and screws. Four auxiliary fixture end suspension points provided. KO's for continuous row wiring. End plates have integral Grid-Lock feature for safety and convenience.

### Electrical\*\*

Ballasts are CBM/ETL Class "P" and are positively secured by mounting bolts. Pressure lock lampholders. UL/CUL listed. Suitable for damp locations.

### Finish

Lighting grade, baked white enamel finish. Multistage, iron phosphate pretreatment ensures maximum bonding and rust inhibition.

### Hinging/Latching

Positive spring loaded, self locking, steel latches. Safety lock T-hinges allow hinging and latching from either side.

<b>Catalog #</b>		<b>Type</b>
<b>Project</b>		
<b>Comments</b>		<b>Date</b>
<b>Prepared by</b>		

### Louver

Die formed of low iridescent, vertical grain anodized aluminum. Finish is Anodic oxide coating. Accurate precision parabolic cells are held in place with interlocking feature. True-cut mitered corners. Black reveal with integral mechanical light seal around entire perimeter of louver. Louver protected from construction contaminants by polyethylene cover.

### Compliance

Options to meet Buy American Act requirements.



**2EP3GX**  
314T5  
324T5

9 Cell

2' X 2' PARABOLIC  
3 T5 LAMPS  
SEMI-SPECULAR,  
SPECULAR OR WHITE  
PAINTED LOUVER

Paralux III  
Recessed Static or Air  
Supply Troffer

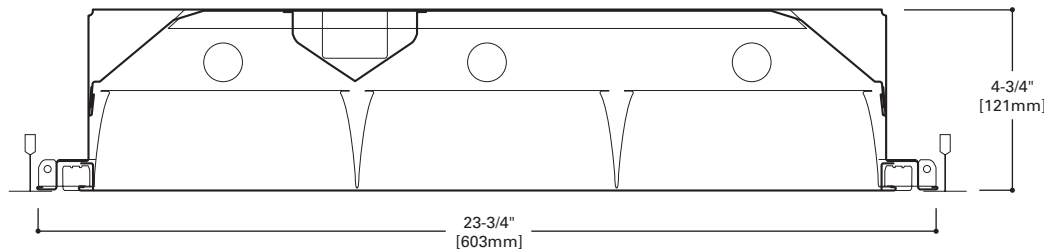

## MOUNTING DATA

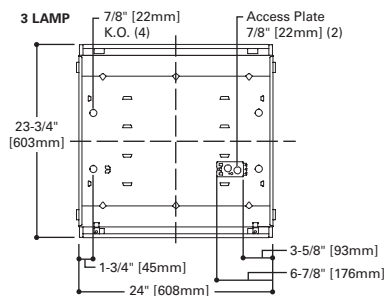

## LAMP CONFIGURATIONS

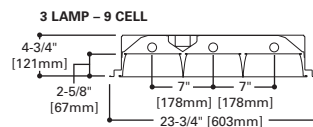

## CEILING COMPATIBILITY

G	G	G	F	MZ	Ceiling Type	Trim Type
Grid/Lay-in Standard	Concealed T	Slot Grid	Aluminum Flange Trim With Supporting Swing Gates	Modular Trim With Supporting Swing Gates	Exposed Grid	G
					Concealed T	G
					Slot Grid	G
					Flange	F
					Concealed "T" or "Z"	MZ
					Metal Pan	MZ
					(Verify compatibility/ consult factory.)	

## ENERGY DATA

Input Watts:  
**EB Ballast & STD Lamps**  
314T5 (57)  
324T5 (80)

\*\*Reference the lamp/ballast data in the Technical Section for specific lamp/ballast requirements.

LAMPS CONTAIN MERCURY. DISPOSE ACCORDING TO LOCAL, STATE OR FEDERAL LAWS

**LINEAR DISCONNECT**

Safe and convenient means of disconnecting power.



ACF111331  
November 30, 2021 8:14 AM

ORDERING INFORMATION

SAMPLE NUMBER: 2EP3GX-314T5S331-UNV-EBT2-U

<p><b>Domestic Preferences</b> <sup>(12)</sup>  <b>[Blank]</b>=Standard  <b>BAA</b>=Buy American Act</p> <p><b>Rating</b>  <b>Blank</b>=Standard  <b>ATW-SW4</b>=Chicago Rated</p> <p><b>HR</b>=Heat Removal <sup>(1)</sup></p> <p><b>Width</b>  <b>2</b>=2' Width  <b>EP</b>=Paralux Louver  <b>3</b>=3" Louver Depth</p> <p><b>Trim Type</b>  <b>G</b>=Grid/Lay-in (Standard)  <b>G</b>=Concealed T/Slot Grid <sup>(7)</sup>  <b>F</b>=Aluminum Flange Trim <sup>(8)</sup>  <b>MZ</b>=Modular Trim</p> <p><b>AX</b>=Air Supply Floating Louver  <b>X</b>=Blank Side/Floating Louver - Non-Air Supply (Omit A)  <b>AVX</b>=Air Supply Floating Louver with Directional Air Vane (Add V)</p>	<p><b>Number of Lamps</b>  <b>3</b>=3 Lamps <sup>(3)</sup></p> <p><b>Wattage</b>  <b>14T5</b>=14W T5 (24")  <b>24T5</b>=24W T5HO (24") 40W</p> <p><b>Louder Color</b>  <b>S</b>=Silver  <b>W</b>=White</p> <p><b>Cell Configuration</b>  <b>33</b>=3 Rows of 3, 9 Cell</p> <p><b>Louder Finish</b>  <b>I</b>=Semi-Specular/Haze (Low Iridescent) Standard (Silver Only)  <b>P</b>=Painted (White only)</p> <p><b>Option - Aluminum Flange Trim</b> <sup>(8)</sup>  <b>Blank</b>=SW (Single White)</p> <table border="1"> <tr> <th>Type</th> <th>Color</th> </tr> <tr> <td>'S' Single</td> <td>'N' Natural</td> </tr> <tr> <td>'R' In Row</td> <td>'W' White</td> </tr> <tr> <td>'E' End of Row</td> <td></td> </tr> </table>	Type	Color	'S' Single	'N' Natural	'R' In Row	'W' White	'E' End of Row		<p><b>Voltage</b> <sup>(4)</sup>  <b>120V</b>=120 Volt  <b>277V</b>=277 Volt  <b>347V</b>=347 Volt  <b>UNV</b>=Universal Voltage 120-277 <sup>(5)</sup></p> <p><b>Options</b>  <b>GL</b>=Single Element Fuse  <b>GM</b>=Double Element Fuse  <b>WTR</b>=White Reveal  <b>Lamps</b>=Lamps Installed (refer to lamp ordering options)  <b>Flex</b>=Flex Installed (Reference Flex ordering information)  <b>EL</b>=Emergency Installed <sup>(6), (11)</sup></p>	<p><b>Ballast Type</b>  <b>EBT</b>__=T5 or T5HO Electronic Program Rapid Start. Total Harmonic Distortion &lt; 10%. Standard Ballast Factor=1.0</p> <p><b>Ballast/Factor Type</b>  <b>EBT_N</b>=T5 Electronic <sup>(9)</sup> Program Rapid Start. Total Harmonic Distortion &lt; 10%. Normal Ballast Factor=.90  <b>EBT_HDIM</b>=T5 Electronic Program Rapid Start. Total Harmonic Distortion &lt; 10%. Step Dimming, High Ballast Factor=1.15</p> <p><b>Number of Ballasts</b>  <b>1</b>=1 Ballast <sup>(10)</sup>  <b>2</b>=2 Ballasts</p>	<p><b>Options</b>  <b>PAF</b>=Painted After Fabrication</p>	<p><b>Packaging</b>  <b>U</b>=Unit Pack  <b>PAL</b>=Job Pack, out of carton  <b>PALC</b>=Job Pack, in carton</p>
Type	Color												
'S' Single	'N' Natural												
'R' In Row	'W' White												
'E' End of Row													

OSQHE3X40DLUNVISNS = ADDED BALLAST

ACCESSORIES <sup>(13)</sup>

EQ-CLIP-U=T-BAR Safety Earthquake Clips <sup>(2)</sup>

NOTES: <sup>(1)</sup> Integral end plate grid lock feature not available in heat removal. <sup>(2)</sup> An EQ Grid Clip is recommended for all 9/16" ceiling systems. Four required per fixture. <sup>(3)</sup> Standard off-center ballast on 3-lamp fixtures. <sup>(4)</sup> Products also available in non-US voltages and frequencies for international markets. <sup>(5)</sup> Not available when specifying emergencies, voltage must be specific. <sup>(6)</sup> Fixtures equipped with "EL" option may require a 5-1/2" housing depth. If installing in field, must use low profile battery pack. <sup>(7)</sup> Louver is recessed by 5/16" in Concealed T or Slot Grid T. <sup>(8)</sup> Specify row configuration, type in catalog number when ordering complete fixture. <sup>(9)</sup> .90 ballast factor available for 2 or 3 14W T5 or 28W T5 lamps only. <sup>(10)</sup> 24T5 only. <sup>(11)</sup> Please specify required voltage, 120V or 277V. <sup>(12)</sup> Only product configurations with this designated prefix are built to be compliant with the Buy American Act of 1933 (BAA). Please refer to DOMESTIC PREFERENCES website for more information. Components shipped separately may be separately analyzed under domestic preference requirements. <sup>(13)</sup> Accessories sold separately will be separately analyzed under domestic preference requirements. Consult factory for further information.

Specifications & dimensions subject to change without notice. Consult your Cooper Lighting Solutions Representative for availability and ordering information.

SHIPPING DATA

Catalog No.	Wt.
2EP3GX-314T5S331	28 lbs.
2EP3GX-324T5S331	28 lbs.



Cooper Lighting Solutions  
 1121 Highway 74 South  
 Peachtree City, GA 30269  
 P: 770-486-4800  
 www.cooperlighting.com

© 2021 Cooper Lighting Solutions  
 All Rights Reserved.  
 Specifications and dimensions  
 subject to change without notice.

ACF111331  
 November 30, 2021 8:14 AM