

COOPER LIGHTING - METALUX®

DESCRIPTION

The Standard Parabolic is a value driven luminaire designed and manufactured for value engineered applications. The luminaire features a nominal 3" deep precision cell parabolic louver and a 4-3/4" deep para-contoured housing for glare control and optimum performance. The series is compatible with all of today's popular ceiling systems and is available with a number of options and accessories for application versatility. The Standard Parabolic is designed to offer maximum value in price sensitive applications. The luminaire is an excellent choice for commercial office spaces, schools, hospitals or retail merchandising areas.

Catalog #	2EP3GX-2U15/8S331-UNV-EL4-ER81-LAO-U	Type	
Project		Date	
Comments			
Prepared by			

SPECIFICATION FEATURES

Construction

4-3/4" deep, para-contoured housing die formed of code gauge, prime cold rolled steel. Die embossed housing has full length die formed stiffeners for added strength. Contoured ballast/wireway cover is easily removed without tools. Die formed captive lampholder bracket fully encloses lampholder wiring permitting easy lampholder replacement. Heavy end plates are securely attached with interlocking tabs and screws. Four auxiliary fixture end suspension points provided. KOs for continuous row wiring. End plates have integral Grid-Lock feature for safety and convenience.

Electrical**

Ballasts are CBM/ETL Class "P" and are positively secured by mounting bolts. Pressure lock lampholders. UL/CUL listed. Suitable for damp locations.

Finish

Lighting grade, baked white enamel finish. Multistage, iron phosphate pretreatment ensures maximum bonding and rust inhibition.

Hinging/Latching

Positive spring loaded, self locking, steel latches. Safety lock T-hinges allow hinging and latching from either side.

Louver

Die formed of low iridescent, vertical grain anodized aluminum. Finish is Anodic oxide coating. Accurate precision parabolic cells are held in place with interlocking feature. True-cut mitered corners. Black reveal with integral mechanical light seal around entire perimeter of louver. Louver protected from construction contaminants by polyethylene cover.



2EP3GX
2U1-5/8
3U1-5/8

9, 12, 16 Cell

2' X 2' PARABOLIC
2 OR 3 LAMP T8
SEMI-SPECULAR,
SPECULAR OR WHITE
PAINTED LOUVER

Paralux III
Recessed Static or
Air Supply Troffer

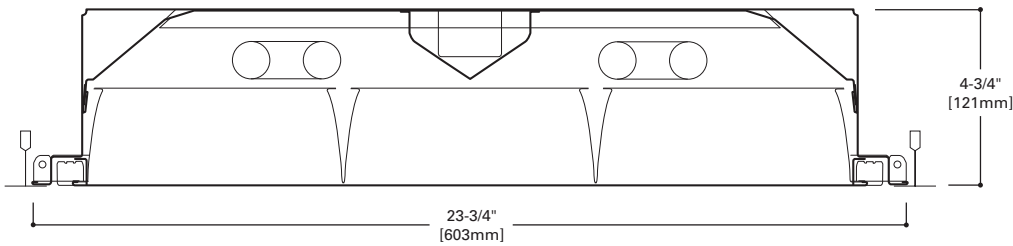

MOUNTING DATA

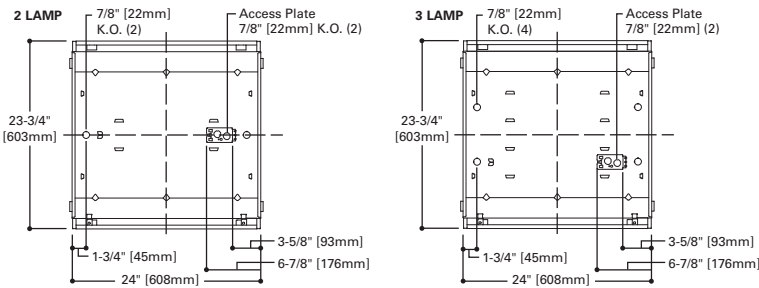

LAMP CONFIGURATIONS

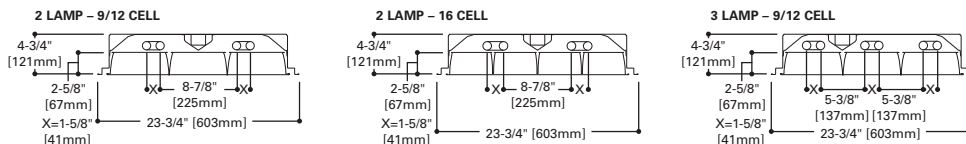

CEILING COMPATIBILITY

G	G	G	F	MZ	Ceiling Type	Trim Type
Grid/Lay-in Standard	Concealed T	Slot Grid	Aluminum Flange Trim With Supporting Swing Gates	Modular Trim With Supporting Swing Gates	Exposed Grid	G
					Concealed T	G
					Slot Grid	G
					Flange	F
					Concealed "T" or "Z"	MZ
					Metal Pan	MZ
					(Verify compatibility/ consult factory.)	

COOPER LIGHTING

ENERGY DATA

Input Watts:
EB Ballast & STD Lamps
2U1-5/8 (61), 3U1-5/8 (91)

Luminaire Efficacy Rating

LER = FP-55

Catalog Number:
2EP3GX-2U1-5/8S331

Yearly Cost of 1000 lumens,
3000 hrs at .08 KWH = \$4.36

**Reference the lamp/ballast data in the Technical Section for specific lamp/ballast requirements.

LAMPS CONTAIN MERCURY. DISPOSE ACCORDING TO LOCAL, STATE OR FEDERAL LAWS

LINEAR DISCONNECT

Safe and convenient means of disconnecting power.

ADF090227



PHOTOMETRICS

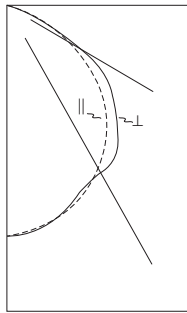

2EP3GX-2U1-5/8S331
 Electronic Ballast
 FBO31/35K Lamps
 2750 Lumens
 Spacing criterion:
 (H) 1.2 x mounting
 height, (L) 1.4 x
 mounting height
 Efficiency 60.7%
 Test Report:
 2EP3GX2U158S331.IES
 LER = FP-55
 Yearly Cost of 1000
 lumens, 3000 hrs at
 .08 KWH = \$4.36

Candlepower

Angle	Along H	45°	Across L
0	1393	1393	1393
5	1387	1385	1383
10	1358	1358	1357
15	1320	1310	1308
20	1269	1251	1286
25	1206	1193	1327
30	1132	1169	1307
35	1046	1140	1226
40	950	1058	1173
45	841	948	1126
50	718	849	1051
55	577	728	874
60	389	519	506
65	177	238	146
70	58	58	46
75	20	20	23
80	8	8	11
85	2	2	4
90	0	0	0

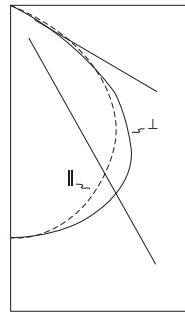

2EP3GAX-3U1-5/8S331
 Electronic Ballast
 FB031/41K Lamps
 2800 Lumens
 Spacing criterion:
 (H) 1.2 x mounting
 height, (L) 1.4 x
 mounting height
 Efficiency 61.9%
 Test Report:
 2EP3GAX3U158S331.IES
 LER = FP-53
 Yearly Cost of 1000
 lumens, 3000 hrs at
 .08 KWH = \$4.53

Candlepower

Angle	Along H	45°	Across L
0	2280	2280	2280
5	2263	2272	2289
10	2216	2261	2312
15	2157	2245	2339
20	2082	2216	2359
25	1983	2169	2360
30	1872	2107	2249
35	1738	1996	2049
40	1583	1803	1895
45	1412	1555	1576
50	1208	1282	958
55	968	861	513
60	648	425	294
65	270	174	122
70	75	57	50
75	26	24	25
80	11	11	11
85	2	2	2
90	0	0	0

Coefficients of Utilization

rc	Effective floor cavity reflectance 20%																	
	80%			70%			50%			30%			10%			0%		
rw	70	50	30	70	50	30	70	50	30	70	50	30	70	50	30	0		
RCR																		
0	72	72	72	71	71	71	67	67	67	65	65	65	62	62	62	61		
1	67	65	63	61	66	64	62	60	61	60	58	59	58	56	57	55	54	
2	62	58	54	51	61	57	54	51	55	52	50	53	51	49	51	49	46	
3	57	52	47	44	56	51	47	43	49	45	43	47	44	42	46	43	41	40
4	53	46	41	38	51	45	41	37	44	40	37	42	39	36	41	38	36	35
5	48	41	36	33	47	41	36	32	39	35	32	38	35	32	37	34	31	30
6	45	37	32	29	44	37	32	28	36	31	28	35	31	28	34	30	28	27
7	42	34	29	25	41	33	29	25	32	28	25	32	28	25	31	27	25	24
8	39	31	26	23	38	30	26	23	30	25	22	29	25	22	28	25	22	21
9	36	28	24	20	35	28	23	20	27	23	20	27	23	20	26	23	20	19
10	34	26	21	18	33	26	21	18	25	21	18	25	21	18	24	21	18	17

Coefficients of Utilization

rc	Effective floor cavity reflectance 20%																	
	80%			70%			50%			30%			10%			0%		
rw	70	50	30	70	50	30	70	50	30	70	50	30	70	50	30	0		
RCR																		
0	74	74	74	72	72	72	69	69	69	66	66	66	63	63	63	62		
1	69	67	65	63	67	65	64	62	63	61	60	61	59	58	58	57	57	55
2	64	60	57	54	63	59	56	53	57	54	52	55	53	51	53	51	50	49
3	59	54	50	46	58	53	49	46	51	48	45	50	47	44	48	46	44	42
4	55	48	44	40	53	48	43	40	46	42	40	45	42	39	44	41	39	37
5	51	44	39	35	50	43	39	35	42	38	35	41	37	34	40	37	34	33
6	47	40	35	31	46	39	35	31	38	34	31	37	33	31	36	33	30	29
7	44	36	31	28	43	36	31	28	35	31	28	34	30	27	33	30	27	26
8	41	33	28	25	40	33	28	25	32	28	25	31	27	25	31	27	25	23
9	38	31	26	23	37	30	26	23	29	25	22	29	25	22	28	25	22	21
10	36	28	24	21	35	28	23	21	27	23	20	27	23	20	26	23	20	19

Zonal Lumen Summary

Zone	Lumens	%Lamp	%Fixture
0-30	1073	19.2	31.6
0-40	1779	31.8	52.4
0-60	3154	56.3	92.8
0-90	3397	60.7	100.0
0-180	3397	60.7	100.0

Typical VCP Percentages

Room Size (Ft.)	Height Along		Height Across	
	8.5'	10.0'	8.5'	10.0'
20 x 20	75	69	74	67
30 x 30	82	76	81	75
30 x 60	85	81	84	79
60 x 30	85	80	83	78
60 x 60	87	84	86	82

Zonal Lumen Summary

Zone	Lumens	%Lamp	%Fixture
0-30	1855	22.1	35.7
0-40	3068	36.5	59.0
0-60	4962	59.1	95.4
0-90	5201	61.9	100.0
0-180	5201	61.9	100.0

Typical VCP Percentages

Room Size (Ft.)	Height Along		Height Across	
	8.5'	10.0'	8.5'	10.0'
20 x 20	71	64	78	74
30 x 30	79	73	84	79
30 x 60	83	78	86	82
60 x 30	81	77	86	82
60 x 60	84	81	88	85

ORDERING INFORMATION

SAMPLE NUMBER: 2EP3GAX-2U1-5/8S331-UNV-EB81-U

<p>Rating Blank= Standard ATW-SW4= Chicago Rated</p> <p>HR=Heat Removal⁽¹⁾</p> <p>Width 2=2' Width</p> <p>EP=Paralux Louver 3=3" Louver Depth</p> <p>Trim Type G=Grid/Lay-in (Standard) G=Concealed T/Slot Grid⁽⁷⁾ F=Aluminum Flange Trim⁽⁸⁾ MZ=Modular Trim</p> <p>AX=Air Supply Floating Louver X=Blank Side/Floating Louver - Non-Air Supply (Omit A) AVX=Air Supply Floating Louver with Directional Air Vane (Add V)</p>	<p>Number of Lamps 2=2 Lamps 3=3 Lamps⁽³⁾</p> <p>Wattage (Length) U1-5/8=31WT8 (24")</p> <p>Louver Color S=Silver W=White</p> <p>Cell Configuration 33=3 Rows of 3, 9 Cell 34=3 Rows of 4, 12 Cell 44=4 Rows of 4, 16 Cell</p> <p>Louver Finish I=Semi-Specular/Haze (Low Iridescent) Standard (Silver Only) MI=Specular/Mirrored (Low Iridescent) (Silver Only) P=Painted (White only)</p> <p>Option - Aluminum Flange Trim⁽⁸⁾ Blank=SW (Single White) Type Color 'S' Single 'N' Natural 'R' In Row 'W' White 'E' End of Row</p>	<p>Voltage⁽⁴⁾ 120V=120 Volt 277V=277 Volt 347V=347 Volt UNV=Universal Voltage 120-277⁽⁵⁾</p> <p>Options GL=Single Element Fuse GM=Double Element Fuse WTR=White Reveal Lamps=Lamps Installed (refer to lamp ordering options) Flex=Flex Installed (Reference Flex ordering information) EL=Emergency Installed⁽⁶⁾</p>	<p>Ballast Type EB8 =T8 Electronic Start. Total Harmonic Distortion < 10%</p> <p>No. of Ballast 1, 2 or 3</p> <p>EB8 /PLUS=T8 Electronic Start. Total Harmonic Distortion < 10% High Ballast Factor >1.15</p> <p>No. of Ballast 1, 2 or 3</p> <p>EB8 =T8 Electronic Program Rapid Start. Total Harmonic Distortion < 10%</p> <p>No. of Ballast 1, 2 or 3</p>	<p>Options PAF=Painted After Fabrication RIF1=Radio Interference Suppressor REP=Riveted Endplates</p> <p>Packaging U=Unit Pack PAL=Job Pack, out of carton PALC=Job Pack, in carton</p>
--	---	--	---	---

ACCESSORIES

EQ-CLIP-U=T-BAR Safety Earthquake Clips⁽²⁾

NOTES: ⁽¹⁾ Integral end plate grid lock feature not available in heat removal. ⁽²⁾ An EQ Grid Clip is recommended for all 9/16" ceiling systems. Four required per fixture. ⁽³⁾ Standard off-center ballast on 3-lamp fixtures. ⁽⁴⁾ Products also available in non-US voltages and frequencies for international markets. ⁽⁵⁾ Not available when specifying emergencies, voltage must be specific. ⁽⁶⁾ Fixtures equipped with "EL" option may require a 5-1/2" housing depth. If installing in field, must use low profile battery pack. ⁽⁷⁾ Louver is recessed by 5/16" in Concealed T or Slot Grid T. ⁽⁸⁾ Specify row configuration, type in catalog number when ordering complete fixture.

For complete product data, reference the Fluorescent Specification binder. Specifications & dimensions subject to change without notice. Consult your Cooper Lighting Representative for availability and ordering information.

SHIPPING INFORMATION

Catalog No.	Wt.
2EP3GX-2U1-5/8S331	28 lbs.
2EP3GX-2U1-5/8S441	28 lbs.
2EP3GX-3U1-5/8S331	28 lbs.
2EP3GX-3U1-5/8S341	28 lbs.
2EP3GX-3U1-5/8S441	28 lbs.

