

DESCRIPTION

The Paralux IV Series features recessed aesthetics and the latest in energy efficient technology. The luminaire incorporates a 4" precision cell louver into a 6-3/4" deep para-contoured fixture housing. This combination creates a high comfort parabolic optical assembly for optimum performance. The series is compatible with all of today's popular ceiling systems and is available with a number of options and accessories for application versatility. The high comfort luminaire is designed to provide a superior visual environment plus the higher shielding louver angle offers excellent cut-off for today's lighting requirements. The Paralux IV series is an excellent choice for commercial spaces, schools, hospitals or retail merchandising areas.

SPECIFICATION FEATURES

Construction

6-3/4" deep, para-contoured housing, die formed code gauge, prime cold rolled steel. Die embossed housing has full length die formed stiffeners for added strength. Deep "V" ballast/wireway cover easily removed without tools. Die formed captive lampholder bracket fully encloses lampholder wiring permitting easy lampholder replacement. Heavy end plates, securely attached with interlocking tabs and screws. Four auxiliary fixture end suspension points provided. KOs for continuous row wiring. End plates have labor saving integral Grid-Lock feature for safety and convenience.

Housing features enable fixture to be converted from Grid to T-option or vice versa in the field.*

Electrical**

Ballast are CBM/ETL Class "P" and are positively secured. 2G11 base lampholders have double-edge wiping action pressure lock contacts with vertically oriented lamp support clips. UL/CUL listed. Suitable for damp locations.

Finish

Lighting grade, baked white enamel finish. Multistage, iron phosphate pretreatment ensures maximum bonding and rust inhibition.

Hinging/Latching

Positive cam action spring loaded, self locking, black steel latches. Safety lock T-hinges allow hinging and latching either side.

Louver

Die formed of semi-specular, vertical grain, aluminum. Finish is anodic oxide coating. Accurate precision parabolic cells are held in place with interlocking feature. True-cut mitered corners. Black reveal with integral mechanical light seal around entire perimeter of louver. Louver protected from construction contaminants by polyethylene cover.



**2PGAX
2BX40
3BX40**

9 Cell

**2' X 2' PARABOLIC
2 OR 3 BIAxIAL SINGLE
ENDED LAMPS
SEMI-SPECULAR LOUVER**

Paralux IV
Recessed Air Supply Troffer

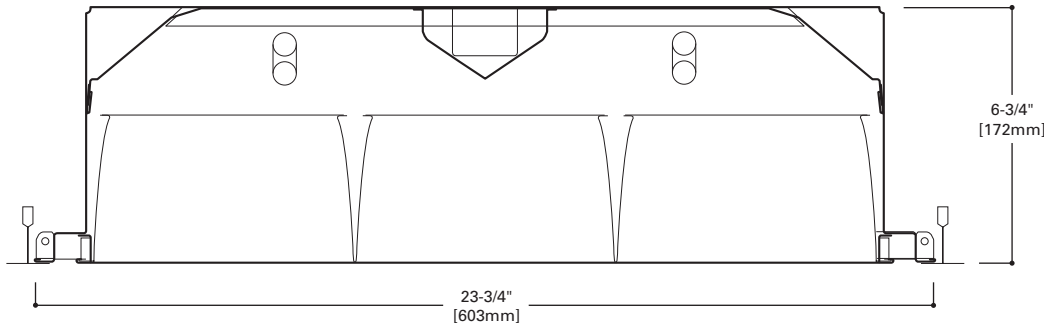

ENERGY DATA

Input Watts:
EB Ballast & STD Lamps
2BX40 (67), 3BX40 (110)

Luminaire Efficacy Rating
LER = FP-55
Catalog Number: 2PGAX-2BX40
Yearly Cost of 1000 lumens,
3000 hrs at .08 KWH = \$4.40

**Reference the lamp/ballast data in the Technical Section for specific lamp/ballast requirements.

MOUNTING DATA

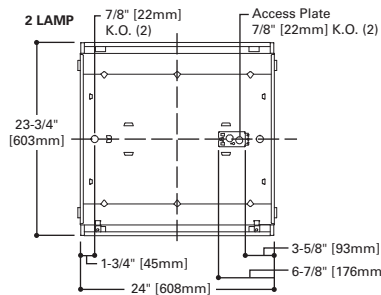

MOUNTING DATA

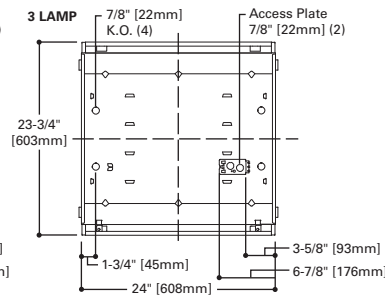

LAMP CONFIGURATIONS

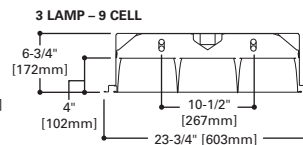
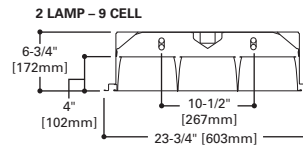

CEILING COMPATIBILITY

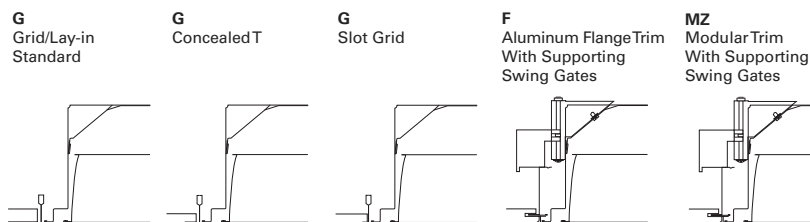

Ceiling Type	Trim Type
Exposed Grid	G
Concealed T	G
Slot Grid	G
Flange	F
Concealed "T" or "Z"	MZ
Metal Pan	MZ

(Verify compatibility/ consult factory.)

LAMPS CONTAIN MERCURY. DISPOSE ACCORDING TO LOCAL, STATE OR FEDERAL LAWS

LINEAR DISCONNECT
Safe and convenient means of disconnecting power.

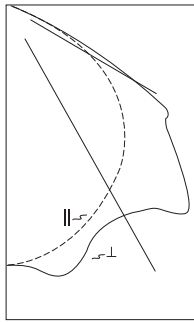

2PGAX-2BX40S331
Electronic Ballast
F40BX/SPX35/RS
Lamps
3150 Lumens
Spacing criterion:
(||) 1.2 x mounting
height, (⊥) 1.6 x
mounting height
Efficiency 63%
Test Report:
2PGX2BX40S331.IES
LER = FP-55
Yearly Cost of 1000
lumens, 3000 hrs at
.08 KWH = \$4.40

Candlepower

Angle	Along	45°	Across ⊥
0	1776	1776	1776
5	1762	1777	1806
10	1721	1777	1807
15	1669	1709	1693
20	1601	1597	1608
25	1520	1491	1526
30	1420	1366	1518
35	1307	1284	1551
40	1179	1231	1607
45	1026	1186	1537
50	843	1070	1124
55	609	785	806
60	298	407	501
65	106	126	177
70	43	51	77
75	21	25	36
80	10	12	14
85	3	4	3
90	0	0	0

Coefficients of Utilization

rc rw	Effective floor cavity reflectance																	
	80%			70%			50%			30%			10%			0%		
RCR	70	50	30	10	70	50	30	10	50	30	10	50	30	10	50	30	10	0
0	75	75	75	75	73	73	73	73	70	70	70	67	67	67	64	64	64	63
1	71	68	66	65	69	67	65	64	64	63	62	62	61	60	60	59	58	57
2	66	62	59	56	65	61	58	56	59	57	54	57	55	53	55	54	52	51
3	61	56	52	49	60	55	52	49	54	51	48	52	49	47	51	48	46	45
4	57	51	47	43	56	50	46	43	49	45	43	48	45	43	46	44	42	40
5	53	46	42	38	52	46	41	38	44	41	38	43	40	37	42	39	37	36
6	49	42	37	34	48	41	37	33	40	36	33	39	36	33	38	35	33	31
7	45	38	33	29	44	37	32	29	36	32	29	35	31	29	35	31	28	27
8	42	34	29	26	41	34	29	26	33	29	26	32	28	25	31	28	25	24
9	39	31	26	23	38	30	26	23	30	26	23	29	25	22	28	25	22	21
10	36	28	23	20	35	28	23	20	27	23	20	27	23	20	26	22	20	19

Zonal Lumen Summary

Zone	Lumens	%Lamp	%Fixture
0-30	1345	21.4	33.9
0-40	2197	34.9	55.4
0-60	3760	59.7	94.7
0-90	3970	63.0	100.0
0-180	3970	63.0	100.0

Typical VCP Percentages

Room Size (Ft.)	Height Along		Height Across	
	8.5'	10.0'	8.5'	10.0'
20 x 20	79	74	73	68
30 x 30	84	79	80	75
30 x 60	87	83	83	78
60 x 30	87	84	83	79
60 x 60	89	86	86	82

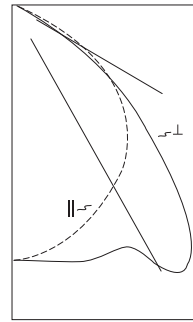

2PGAX-3BX40S331
Electronic Ballast
F40BX/SPX35/RS
Lamps
3150 Lumens
Spacing criterion:
(||) 1.2 x mounting
height, (⊥) 1.7 x
mounting height
Efficiency 65.4%
Test Report:
2PGX3BX40S331.IES
LER = FP-55
Yearly Cost of 1000
lumens, 3000 hrs at
.08 KWH = \$4.33

Candlepower

Angle	Along	45°	Across ⊥
0	2766	2766	2766
5	2750	2753	2783
10	2691	2742	2832
15	2613	2735	2948
20	2512	2750	3100
25	2393	2768	3213
30	2247	2749	3158
35	2082	2644	2703
40	1888	2340	1941
45	1656	1777	1393
50	1366	1165	1032
55	997	756	864
60	481	426	584
65	171	162	239
70	67	67	97
75	33	33	43
80	14	14	17
85	4	3	3
90	0	0	0

Coefficients of Utilization

rc rw	Effective floor cavity reflectance																	
	80%			70%			50%			30%			10%			0%		
RCR	70	50	30	10	70	50	30	10	50	30	10	50	30	10	50	30	10	0
0	78	78	78	78	76	76	76	76	73	73	73	70	70	70	67	67	67	65
1	73	71	69	65	72	70	68	66	67	66	64	65	64	62	62	61	61	59
2	69	65	62	59	68	64	61	59	62	59	57	60	58	56	58	56	55	54
3	64	59	55	52	63	58	55	52	57	54	51	55	53	50	54	51	49	48
4	60	54	50	47	59	54	50	46	52	49	46	51	48	45	49	47	45	44
5	56	50	45	41	55	49	44	41	48	44	41	46	43	40	45	42	40	39
6	52	45	40	37	51	44	40	37	43	39	36	42	39	36	41	38	36	35
7	48	41	35	33	47	40	36	32	39	35	32	38	35	32	38	34	32	31
8	45	37	32	29	44	37	32	29	36	32	29	35	31	29	34	31	28	27
9	42	34	29	26	41	33	29	26	33	28	26	32	28	25	31	28	25	24
10	39	31	26	23	38	30	26	23	30	26	23	29	25	23	29	25	22	21

Zonal Lumen Summary

Zone	Lumens	%Lamp	%Fixture
0-30	2326	24.6	37.7
0-40	3867	40.9	62.6
0-60	5914	62.6	95.7
0-90	6178	65.4	100.0
0-180	6178	65.4	100.0

Typical VCP Percentages

Room Size (Ft.)	Height Along		Height Across	
	8.5'	10.0'	8.5'	10.0'
20 x 20	73	66	74	67
30 x 30	80	73	80	73
30 x 60	83	77	83	77
60 x 30	82	78	83	78
60 x 60	85	81	86	81

ORDERING INFORMATION

SAMPLE NUMBER: 2PGAX-2BX40S331-120V-EB51-U

<p>Rating Blank=Standard ATW-SW4=Chicago Rated</p> <p>HR=Heat Removal⁽¹⁾</p> <p>Width 2=2' width</p> <p>P=Paralux IV</p> <p>Trim Type G=Grid/Lay-in (Standard) G=Concealed T/Slot Grid⁽⁷⁾ F=Aluminum Flange Trim⁽⁸⁾ MZ=Modular Trim</p> <p>AX=Air Supply Floating Louver X=Blank Side/Floating Louver - Non-Air Supply (Omit A) AVX=Air Supply Floating Louver with Directional Air Vane (Add V)</p>	<p>Number of Lamps 2=2 Lamps 3=3 Lamps⁽³⁾</p> <p>Wattage (Length) BX40=40W Biax (24")</p> <p>Louder Color S=Silver W=White</p> <p>Cell Configuration 36=3 Rows of 3, 9 Cell (2' x 2')</p> <p>Louder Finish I=Semi-Specular/Haze (Low Iridescent) Standard MI=Specular/Mirrored (Low Iridescent) P=Painted</p> <p>Option - Aluminum Flange Trim⁽⁸⁾ Blank=SW (Single White) Type Color 'S' Single 'N' Natural 'R' In Row 'W' White 'E' End of Row</p>	<p>Voltage⁽⁴⁾ 120V=120 Volt 277V=277 Volt 347V=347 Volt UNV=Universal Voltage 120-277⁽⁵⁾</p> <p>Options GL=Single Element Fuse GM=Double Element Fuse WTR=White Reveal Lamps=Lamps Installed (refer to lamp ordering options) Flex=Flex Installed (Reference Flex ordering information) EL=Emergency Installed⁽⁶⁾</p>	<p>Ballast Type EB_EB8=T8 Electronic Start. Total Harmonic Distortion < 10%</p> <p>No. of Ballast 1 or 2</p> <p>TEB5_=T5 Biax Electronic Instant Start.⁽⁹⁾ Total Harmonic Distortion < 10%</p> <p>No. of Ballast 1 or 2</p> <p>ER5_=T5 Biax Electronic Program Rapid Start. Total Harmonic Distortion < 10%</p> <p>No. of Ballast 1 or 2</p>	<p>Options PAF=Painted After Fabrication REP=Riveted Endplates</p> <p>Packaging U=Unit Pack PAL=Job Pack, out of carton PALC=Job Pack, in carton</p>
--	---	--	---	--

ACCESSORIES

EQ-CLIP-U=T-BAR Safety Earthquake Clips⁽²⁾

SHIPPING DATA

Catalog No.	Wt.
2PGAX-2BX40S331	29 lbs.
2PGAX-3BX40S331	29 lbs.

NOTES: ⁽¹⁾ Integral End Plate Grid Lock feature not available in Heat Removal. ⁽²⁾ An EQ Grid Clip is recommended for all 9/16" ceiling systems. Four required per fixture. ⁽³⁾ Standard off-center ballast on 3-lamp fixtures. ⁽⁴⁾ Products also available in non-US voltages and frequencies for international markets. ⁽⁵⁾ Not available when specifying emergencies, voltage must be specific. ⁽⁶⁾ Fixtures equipped with "EL" option may require a 7-1/2" housing depth. If installing in field, must use low profile battery pack. ⁽⁷⁾ Louver is recessed by 5/16" in Concealed T or Slot Grid T. ⁽⁸⁾ Specify row configuration, type in catalog number when ordering complete fixture. ⁽⁹⁾ Not available in UNV voltages. Must specify voltage.

For complete product data, reference the Fluorescent Specification binder. Specifications & dimensions subject to change without notice. Consult your Cooper Lighting Representative for availability and ordering information.