

DESCRIPTION

The Metalux Horizon Recessed Wall Wash Series features recessed aesthetics and the latest in Energy Efficient Technology. The clean architectural design incorporates precision-formed aluminum reflector features that produces efficient, uniform and continuous vertical wall illumination.

The Horizon Recessed Wall Wash Series is specifically designed for effective use in various retail, merchandising and commercial wall washing environments. Horizon is ideal for retail displays, showrooms, corridor walls, art lighting and the elimination of the "Cave Effect" in office lighting applications.

Catalog #		Type
Project		
Comments		Date
Prepared by		

SPECIFICATION FEATURES

Construction

Nominal 4-1/2" deep 10" x 2' housing designed for use with 40, 50 and 55 watt biaxial 17W T8 lamps. The housing is constructed of die formed code gauge prime cold rolled steel. Housing incorporates a longitudinal flange for grid installation or ceiling tile support. KO's for continuous row mounting.

Electrical*

Ballasts are CBM/ETL Class "P" and are positively secured. Biax models use 2G11 base lampholders with double-edge wiping action pressure lock contacts and lamp support clips. T8 models use pressure-lock lampholders. UL/CUL listed. Suitable for damp locations.

Finish

Electrostatically applied baked white polyester powder enamel finish. Multistage cleaning cycle, iron phosphate coating with rust inhibitor. Conveyorized application and baking timing accurately controlled an eleat vated temperature.

Reflector Optical Assembly

The internal aluminum reflector optical assembly incorporates an upper "Scoop" and lower "Kick" reflector design. This design produces uniform even illumination on vertical surfaces. Continuous illumination is maintained to the junction of the wall and the ceiling. Reflectors are precision manufactured from specular low iridescent aluminum in a computer-controlled operation.



RWW
1BX40
117
217

1' X 2'
RECESSED WALL WASH
BIAxIAL OR T8 LAMPS

Vertical Illumination
Luminaire



ENERGY DATA

Input Watts:

Electronic Ballast & STD Lamps

- 1BX40 (43)
- 1BX50 (54)
- 1BX55 (60)
- 117 (19)
- 217 (34)

STD Ballast & STD Lamps

- 1BX40 (48)
- 117 (23)
- 217 (45)

ES Ballast & STD Lamps

- 117 (23)
- 217 (45)

*Reference the lamp/ballast data in the Technical Section for specific lamp/ballast requirements.

LAMPS CONTAIN MERCURY. DISPOSE ACCORDING TO LOCAL, STATE OR FEDERAL LAWS

LINEAR DISCONNECT

Safe and convenient means of disconnecting power.

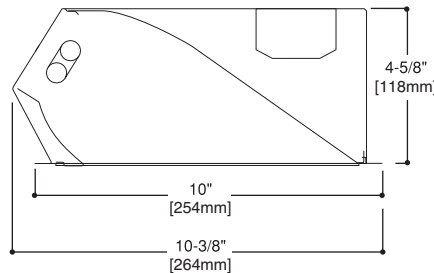

MOUNTING DATA

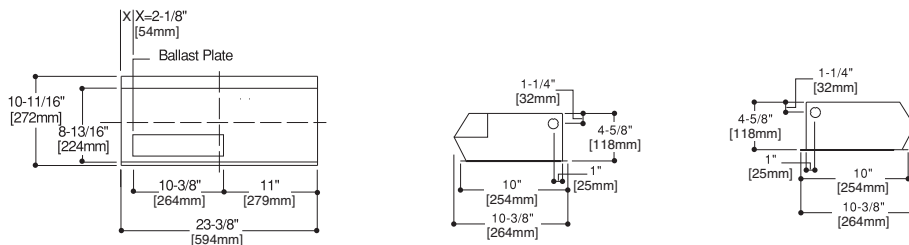

INSTALLATION DATA

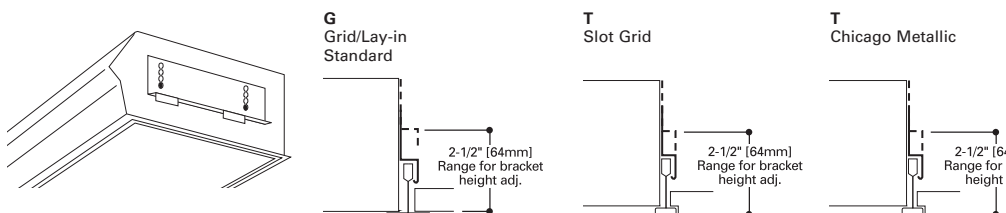

PHOTOMETRICS

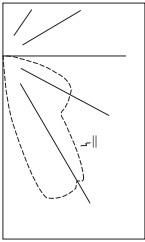

RWW-1BX40MI Electronic Ballast F14T5/835 Lamps 3150 Lumens Efficiency 80.4% Test Report #167P117

Candlepower

Table with columns: Angle, Along ll, 45°, Across ⊥. Rows from 0 to 90 degrees.

Zonal Lumen Summary

Table with columns: Zone, Lumens, %Lamp, %Fixture. Rows for zones 0-30, 0-40, 0-60, 0-90, 0-180.

Coefficients of Utilization

Table with columns: rc, rw, RCR and Effective floor cavity reflectance (80%, 70%, 20%) for various room dimensions.

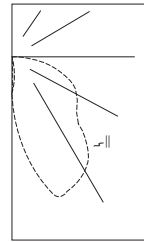

RWW-217MI Electronic Ballast F17T8/835 Lamps 1400 Lumens Efficiency 66.9% Test Report #167P116

Candela

Table with columns: Angle, Along ll, 45°, Across ⊥. Rows from 0 to 90 degrees.

Zonal Lumen Summary

Table with columns: Zone, Lumens, %Lamp, %Fixture. Rows for zones 0-30, 0-40, 0-60, 0-90, 0-180.

Coefficients of Utilization

Table with columns: rc, rw, RCR and Effective floor cavity reflectance (80%, 70%, 20%) for various room dimensions.

WALL ILLUMINANCE

Table showing wall illuminance for Individual Unit*, Multiple Units*, and Continuous Row* at various distances from the wall.

*Units located 3' from wall. Data provided for RWW-232MI Unit

Fixture Location: 36" from center of luminaire to wall. Mounting Height: 9ft.

ORDERING INFORMATION

SAMPLE NUMBER: RWW-1BX40MI-120V-EB51-U

Ordering information details including Series (RWW=Recessed Wall Wash), Louver Finish (I=Specular/Haze, MI=Specular/Mirrored), Ballast Type (Blank, EB8, ER8, EB5, TEBS, ER5), Options (GL, GM, EL), Accessories (CAL2, CAL4, DF-102-W), Packaging (U=Unit Pack, PALC=Job Pack), and ISNSC logo.

NOTES: (1) Products also available in non-US voltages and frequencies for international markets. (2) UNV available in T5 and T8 linear only. (3) Electronic ballast only. (4) Biax only available in 1 lamp cross section. (5) Not available in UNV voltages. Must specify voltage.

SHIPPING DATA

Table with columns: Catalog No., Wt. Rows for RWW-1BX40, RWW-117, RWW-217.



Eaton 1121 Highway 74 South Peachtree City, GA 30269 P: 770-486-4800 www.eaton.com/lighting

Specifications and dimensions subject to change without notice.