

## DESCRIPTION

The VT3 Series is a contemporary looking energy efficient industrial Vaportite fixture that features rugged and durable construction. The VT3 incorporates a full metal gear tray inside a reinforced fiberglass housing with a high impact diffuser. This Vaportite series is suitable for interior and exterior applications and can be surface or chain mounted.

The VT3 Series has been designed for maximum operation in commercial institutional and industrial environments where weathering, high temperature, humidity and dust or corrosive fumes are present.

## SPECIFICATION FEATURES

### Construction

Fiberglass housing is reinforced polyester and self-extinguishing (ASTM-D635-74) plastic of a permanent pearl gray color. Top of housing has five embossments (2' unit), nine embossments (4' unit) and thirteen embossments (8' unit), providing mounting flexibility on uneven surfaces. A watertite hub for 1/2" conduit entry is provided at each end of housing (standard) for continuous feed. Polyurethane gasketing is formed in the housing providing a continuous seamless seal for the diffuser. Six sturdy cam latches clamp diffuser tightly for a positive seal between housing, gasketing and diffuser.

### Electrical\*

Unit has full metal gear tray secured by internal fasteners and tethers providing maximum protection and rigidity. Ballasts are CBM/ETL Class "P" certified suitable to 70°F. (Cold temperature ballasts are available for less than 0°F starting with EHT (T5HO only), EB/PLUS and ER/PLUS ballasts). Rotor lock lampholders. Electrical components and fixture are UL/CUL listed for Wet Locations.\*\* IP65 approved with optional IP67 rating (4' only) with 8 latches. NSF certified.

### Shielding

New contemporary styled lens clear acrylic w/impact resistant additives and linear prisms. "DR" - Clear low brightness pattern acrylic with 15% high impact additive. "DR-100" - Clear low brightness pattern acrylic with 100% high impact additive. Example: VT3-232DR-100.

### Mounting

Surface mount fixture using two (2) galvanized brackets (included per 4' section). Optional chain mount hanging set or snap-on brackets are also available.

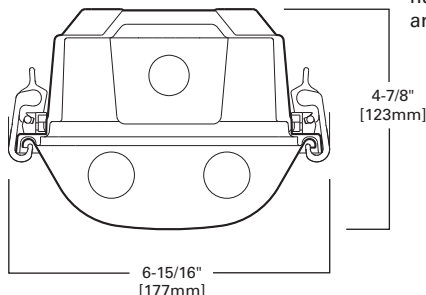

**VT3**  
132  
232  
332  
154T5  
254T5  
354T5

**4' OR 8' INDUSTRIAL**  
1, 2 OR 3 LAMP

Vaportite Industrial

## LAMP CONFIGURATIONS

### 1 LAMP

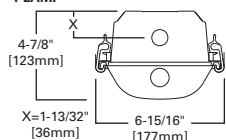

### 2 LAMP

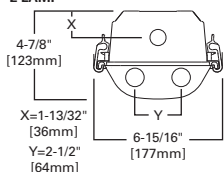

### 3 LAMP

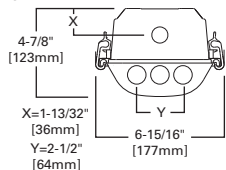

## MOUNTING DATA

### 4 FOOT

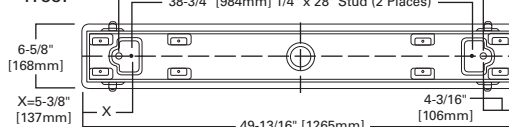

## INSTALLATION DATA



### MOUNTING BRACKETS

Furnished  
Two per  
4' Unit  
Four per  
8' Unit

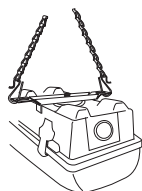

**OPTIONAL CHAIN HANGING SET**  
(VT2-CHAIN/SET-U)  
Includes 6 ft. of chain, 4 large S-Hooks and 4 small S-Hooks  
Order Two (2) Kits for each 8' Fixture

### Relative Light Output Factors

To accurately predict how luminaires will perform in cold temperatures, Cooper Lighting Solutions individually tested each configuration in the different ambient environments. The relative light output factor should be applied as an additional light loss factor component.

VT3 Series	-15°F (-26°C)	0°F (-18°C)	20°F (-6°C)	33°F (0°C)	50°F (10°C)
VT3-232	n/a	n/a	0.67	0.97	0.99
VT3-254	0.73	0.76	0.86	0.90	0.94
VT3-332	n/a	n/a	0.96	0.98	0.98
VT3-354	0.91	0.93	n/a	n/a	n/a

## ENERGY DATA

Input Watts:

**EB Ballast & STD Lamps**  
132 (30)  
232 (61)  
154T5 (54)  
254T5 (106)

Luminaire Efficacy Rating

**LER = FL-73**

**Catalog Number:** VT3-232 DR

**Yearly Cost of 1000 lumens,**  
**3000 hrs at .08 KWH = \$3.29**

\*Reference the lamp/ballast data in the Technical Section for specific lamp/ballast requirements.

\*\*Not Suitable for Wet Locations if EL4 Option is added. Consult Pre Sales Technical Support.

**LAMPS CONTAIN MERCURY. DISPOSE ACCORDING TO LOCAL, STATE OR FEDERAL LAWS**

**LINEAR DISCONNECT**

Safe and convenient means of disconnecting power.

PHOTOMETRICS

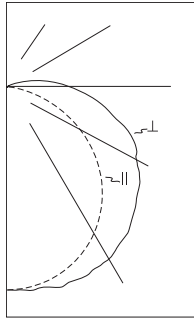

**VT3-232DR-UNV-EB81-WL-U**

(1) Electronic Ballasts  
 (2) 32WT8 lamps  
 2850 lumens  
 Spacing criterion:  
 (H) 1.3 x mounting  
 height, (L) 1.5 x  
 mounting height  
 Efficiency 77.4%  
 Test Report:  
 LTL10864.IES  
 LER =FL72  
 Yearly Cost of 1000  
 lumens, 3000 hrs at  
 .08 KWH = \$3.34

**Candela**

Angle	Along H	45°	Across L
0	1103	1103	1103
5	1097	1108	1107
10	1083	1107	1106
15	1059	1091	1127
20	1025	1089	1113
25	983	1058	1098
30	932	1035	1088
35	870	991	1052
40	801	952	1024
45	725	892	971
50	640	831	920
55	548	753	878
60	451	683	814
65	352	611	771
70	251	550	698
75	155	471	592
80	77	367	513
85	28	290	427
90	6	217	342

**Coefficients of Utilization**

rc	Effective floor cavity reflectance																	
	80%			70%			50%			30%			10%			0%		
rw	70	50	30	70	50	30	50	30	10	50	30	10	50	30	10	0		
RCR																		
0	91	91	91	91	89	89	89	89	84	84	84	79	79	79	75	75	75	73
1	82	78	74	70	79	75	72	69	71	68	66	67	65	63	64	62	60	58
2	74	67	61	56	71	65	60	55	61	57	53	58	54	51	55	52	49	47
3	67	58	52	46	65	57	51	46	54	49	44	51	47	43	49	45	42	40
4	61	51	44	39	59	50	43	38	48	42	37	45	40	36	43	39	35	33
5	56	45	38	32	54	44	37	32	42	36	31	40	34	30	38	33	30	28
6	51	40	33	28	49	39	32	27	37	31	27	36	30	26	34	29	26	24
7	47	36	29	24	45	35	28	23	33	27	23	32	27	23	30	26	22	20
8	43	32	25	20	42	31	25	20	30	24	20	29	23	19	27	23	19	17
9	40	29	22	17	38	28	22	17	27	21	17	26	20	17	25	20	16	15
10	37	26	20	15	36	26	19	15	24	19	15	23	18	15	22	18	14	13

**Zonal Lumen Summary**

Zone	Lumens	%Lamp	%Fixture
0-30	899	15.8	20.4
0-40	1512	26.5	34.3
0-60	2847	49.9	64.5
0-90	4169	73.1	94.5
0-180	4413	77.4	100.0

**Luminaire Data**

Angle in Deg	Average 0-Deg cd/sm	Average 45-Deg cd/sm	Average 90-Deg cd/sm
45	5519	7213	7212
55	5083	6756	7098
65	4347	6377	7074
75	3001	6097	6510
85	1349	5151	6092

ORDERING INFORMATION

SAMPLE NUMBER: VT3-232DR-UNV-EB81-WL-U

**Tandem**  
Blank= 4' Length  
8T=8' Length

**Series**  
VT3=Vaportite (Gasketed Enclosure)

**Number of Lamps**<sup>(3)</sup>  
1=1 Lamp  
2=2 Lamps  
3=3 Lamps  
(Lamps not included)

**Wattage (Length)**  
32=32WT8 (48")  
28T5=28WT5 (48")  
54T5=54WT5HO (48")<sup>(3)</sup>

**Lens**  
DR=Internal Prismatic Lens/15% DR High Impact Additive (Standard)  
DR-50=50% High Impact Additive  
DR-100=100% High Impact Additive (Extreme)

**Voltage**<sup>(1)</sup>  
120V=120 Volt  
277V=277 Volt  
347V=347 Volt  
UNV=Universal Voltage 120/277<sup>(2)</sup>  
UNC=Universal Voltage 347/480<sup>(6)</sup>

GL=Single Element Fuse  
GM=Double Element Fuse  
VT-REM-\_\_ (specify battery)= Remote Emergency Enclosure <sup>(4)</sup>

NOTES: <sup>(1)</sup> Ballast type used only if ballast & voltage is chosen. <sup>(2)</sup> Not available when specifying emergency ballasts, voltage must be specific. <sup>(3)</sup> EHT2 ballasts are recommended for ambient temperatures above 102°F (40°C) 3 Lamp 54W T5HO configurations. <sup>(4)</sup> Rated for operation up to 30C. <sup>(5)</sup> Top Hub required when stem mounting. <sup>(6)</sup> 2/3 lamp ballast configurations in EB8/PLUS only for T8 UNC version. <sup>(7)</sup> Use EHT1 ballast in ambient temperatures below 0°F (-18°C) on 3 Lamp 54W T5HO configurations. <sup>(8)</sup> Example: VT3-232DR-UNV-EB81-WL-GT4-U. See stock guide online for stock items. <sup>(9)</sup> Order one (1) kit for 4ft. fixture, or two (2) kits for 8ft. fixture.

Specifications & dimensions subject to change without notice. Consult your Cooper Lighting Solutions Representative for availability and ordering information.



Cooper Lighting Solutions  
 1121 Highway 74 South  
 Peachtree City, GA 30269  
 P: 770-486-4800  
 www.cooperlighting.com

Specifications and dimensions subject to change without notice.

PHOTOMETRICS

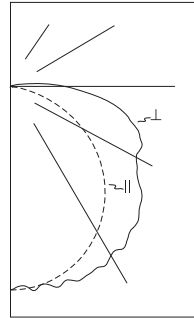

**VT3-254T5DR-UNV-EHT1-WL-U**

(1) Electronic Ballasts  
 (2) 54WT5 lamps  
 4400 lumens  
 Spacing criterion:  
 (H) 1.2 x mounting  
 height, (L) 1.5 x  
 mounting height  
 Efficiency 69.7%  
 Test Report:  
 LTL10777.IES  
 LER =FL59  
 Yearly Cost of 1000  
 lumens, 3000 hrs  
 at .08 KWH = \$4.05

**Candela**

Angle	Along H	45°	Across L
0	1546	1546	1546
5	1540	1525	1533
10	1519	1548	1525
15	1483	1514	1546
20	1436	1509	1566
25	1375	1487	1530
30	1300	1446	1509
35	1215	1396	1502
40	1118	1315	1425
45	1012	1267	1384
50	896	1174	1308
55	770	1081	1179
60	634	954	1107
65	496	827	1101
70	352	771	1044
75	219	704	936
80	113	578	807
85	47	432	614
90	13	285	431

**Coefficients of Utilization**

rc	Effective floor cavity reflectance																	
	80%			70%			50%			30%			10%			0%		
rw	70	50	30	70	50	30	50	30	10	50	30	10	50	30	10	0		
RCR																		
0	82	82	82	82	80	80	80	80	76	76	76	72	72	72	69	69	69	67
1	74	70	66	63	72	68	65	62	65	62	59	61	59	57	58	57	55	53
2	66	60	55	50	64	58	54	49	55	51	48	53	49	46	50	47	45	43
3	60	52	46	41	58	51	45	41	49	44	40	46	42	39	44	41	38	36
4	55	46	40	35	53	45	39	34	43	38	33	41	36	33	39	35	32	30
5	50	40	34	29	48	40	33	29	38	32	28	36	31	27	34	30	27	25
6	46	36	29	25	44	35	29	24	34	28	24	32	27	24	31	26	23	22
7	42	32	26	21	41	32	25	21	30	25	21	29	24	20	28	23	20	18
8	39	29	23	18	38	28	22	18	27	22	18	26	21	17	25	20	17	16
9	36	26	20	16	35	25	19	15	24	19	15	23	18	15	22	18	15	13
10	33	23	18	14	32	23	17	14	22	17	13	21	17	13	20	16	13	12

**Zonal Lumen Summary**

Zone	Lumens	%Lamp	%Fixture
0-30	1253	14.2	20.4
0-40	2112	24.0	34.4
0-60	3985	45.3	64.9
0-90	5908	67.1	96.3
0-180	6137	69.7	100.0

**Luminaire Data**

Angle in Deg	Average 0-Deg cd/sm	Average 45-Deg cd/sm	Average 90-Deg cd/sm
45	7704	10245	10245
55	7142	9700	9531
65	6126	8631	10102
75	4240	9114	10293
85	2265	7674	8760

**Ballast Type**<sup>(1)</sup>  
**EB8** =T8 Electronic Start.  
 Total Harmonic Distortion < 10%  
**EB8\_/PLUS**= T8 Electronic Start. <sup>(6)</sup>  
 Total Harmonic Distortion < 10%. High Ballast Factor > 1.13.  
**ER8** =T8 Electronic Program  
 Rapid Start. Total Harmonic Distortion < 10%  
**ER8\_/PLUS**= T8 Electronic Program  
 Rapid Start. Total Harmonic Distortion < 10%. High Ballast Factor > 1.15.  
**EHT** =T5/T5HO Electronic Program Rapid Start.  
 Total Harmonic Distortion < 10%. Standard Ballast Factor=1.0  
**EHT** =T5HO Linear Electronic <sup>(3)</sup> <sup>(7)</sup>  
 Start High Ambient. Total Harmonic Distortion < 10%

**WL=Wet Location Label**

**Options**  
 8L=8 Latches (IP67 Rating), (4' only)  
 TH=(2) Top Watertite Hubs<sup>(5)</sup>  
 TEH=(2) Top & (2) End Watertite Hubs (all Watertite Hubs have 1/2" Conduit Entry)<sup>(5)</sup>  
 BKS=(2) Snap-on Brackets for Chain or Surface Mount  
 M4=Specular Reflector  
 SSL=Stainless Steel Latches  
 VRS=Vandal Resistant Screws for Latches  
 GT4=Stock product only<sup>(8)</sup>

**Accessories** (order separately)  
 VT2 Stem Bushing=1/2" - 3/8" (Required when using Stem/Sets, Requires (1) per (Stem/Set)  
 VT2-Chain/Set-U=Chain Hanging Set Includes 6 ft. of chain, 4 large S-Hooks and 4 small S-Hooks. <sup>(9)</sup>  
 VT2-SS-MBK=Stainless Steel Mounting Brackets. <sup>(9)</sup>  
 VT3-BKS2-PK=(2) Snap-on Brackets for Surface or Chain Mount. Adjustable along length of fixture.  
 VT3-4FT-M4 PK=4' Specular Interior Reflector Pack for VT3 (stock product)

**Number of Ballasts**  
 1=1 Ballast  
 2=2 Ballasts

SHIPPING DATA

Catalog No.	Wt.
VT3-132 DR-WL	16 lbs.
VT3-232 DR-WL	16 lbs.
VT3-154T5	16 lbs.
VT3-254T5	16 lbs.