

# Model: EN-Q50AR

## 120V Track Systems Fixture Adapter

# WAC LIGHTING

Responsible Lighting®

 Fixture Type: 

 Catalog Number: 

Project: \_\_\_\_\_

Location: \_\_\_\_\_

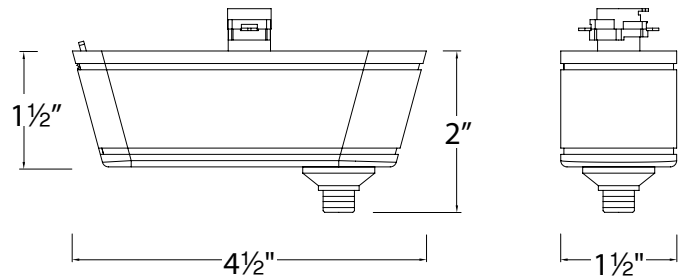

### PRODUCT DESCRIPTION

The threaded male adapter used on Quick Connect™ fixtures makes inter-system compatibility a snap. Simply insert the metal fitting into the appropriate system adapter, hand tighten the threaded collar and you are done!

### FEATURES

- Order one per Quick Connect™ fixture or pendant used.
- 1W minimum load required. 50W maximum load.
- Compatible fixtures include all the elements in the WAC Lighting Quick Connect™ series of pendants and track heads.
- Dimmable with ELV (Electronic Low Voltage) dimmer.

### SPECIFICATIONS

**Transformer:** Electronic transformer has advanced auto-reset, soft start and short circuit protection features. The soft start delayed lamp start feature extends lamp life by delaying the abrupt inrush current to the lamp.

**Materials:** Polycarbonate case with metal fittings for attaching to rail. Transformer is a high frequency 12V electronic transformer.

**Finishes:** Brushed Nickel (BN), Black (BK), Dark Bronze - H Track only (DB), and White (WT).

**Standards:** UL and CUL Listed.

### ORDER NUMBER

Model #	Finish
<b>EN-HQ50AR</b> H Track	<b>BK</b> Black
	<b>BN</b> Brushed Nickel
	<b>DB</b> Dark Bronze
	<b>WT</b> White
<b>EN-LQ50AR</b> L Track	<b>BK</b> Black
	<b>BN</b> Brushed Nickel
<b>EN-JQ50AR</b> J/J2 Track	<b>BN</b> Brushed Nickel
	<b>WT</b> White



Example: **EN-HQ50AR-BK**



WAC Lighting  
www.waclighting.com  
Phone (800) 526.2588 • Fax (800) 526.2585

Headquarters/Eastern Distribution Center  
615 South Street • Garden City, NY 11530  
Phone (516) 515.5000 • Fax (516) 515.5050

Western Distribution Center  
168 Brea Canyon Road • City of Industry, CA 91789  
Phone (800) 526.2588 • Fax (800) 526.2585